

MANUAL | QUICK START GUIDE

SABRE v2 PRO

ULTRALIGHT WIRELESS GAMING MOUSE



CHARGING THE MOUSE

IMPORTANT: The SABRE v2 PRO gaming mouse must be fully charged before its first use.

Connect the mouse to an available USB 2.0 or 3.x port on your PC with the USB CHARGING/DATA CABLE (K). The lights under the MIDDLE CLICK/SCROLL WHEEL (C) on the mouse will light up according to the battery status and will turn solid green when charging is complete.

GETTING TO KNOW YOUR MOUSE



- A. LEFT MOUSE BUTTON
 - B. RIGHT MOUSE BUTTON
 - C. MIDDLE CLICK/SCROLL WHEEL
 - D. FORWARD BUTTON
 - E. BACK BUTTON
 - F. MARKSMAN S OPTICAL SENSOR
 - G. USB CHARGING/DATA PORT
 - H. 100% VIRGIN-GRADE UPE MOUSE SKATES
 - I. POWER ON/OFF SWITCH
 - J. USB WIRELESS RECEIVER
 - K. USB CHARGING/DATA CABLE
- GRIP TAPE
 - EXTRA MOUSE SKATES
 - WARRANTY LEAFLET

SETTING UP 2.4GHz WIRELESS

- Connect the USB WIRELESS RECEIVER (J) to the USB CHARGING/DATA CABLE (K), plug the other side of the cable to an available USB 2.0 or 3.x port located on the front panel of your PC or nearby USB port.
- Power on your mouse by switching the POWER ON/OFF SWITCH (I) to ON.
- The LED indicator under the MIDDLE CLICK/SCROLL WHEEL (C) will light up to the corresponding DPI color it was last set to for 3 seconds before turning off.

CYCLING THROUGH DPI PROFILES

On-the-fly pre-defined DPI cycling is available for fast configuration.

- Long press the RIGHT MOUSE BUTTON(B) and the BACK BUTTON(E) for 3 seconds to switch to next DPI stage.
- When switching to the corresponding DPI level, the indicator light on the mouse wheel will flash 3 times for the corresponding DPI color and then turn off.
- Repeat the above steps to switch to the next DPI stage. It will cycle through 5 DPI stages and return to Stage 1.

Advanced configurations are available via CORSAIR WEB HUB.



MOUSE STATUS AND INDICATIONS

Wireless connection and battery status are communicated through the lights under the MIDDLE CLICK/SCROLL WHEEL (C).

DPI STATUS - PREDEFINED	LED INDICATOR
STAGE 1 - 400	RED
STAGE 2 - 800	BLUE
STAGE 3 - 1200	GREEN
STAGE 4 - 1600	YELLOW
STAGE 5 - 2000	PURPLE

BATTERY STATUS	LED INDICATOR
BATTERY CHARGING WHEN LOW	BREATHING RED
BATTERY CHARGING WHEN MEDIUM	BREATHING GREEN
BATTERY FULL	SOLID GREEN
BATTERY CRITICAL, RECHARGE REQUIRED	BREATHING RED

BATTERY REMOVAL INFORMATION

This product uses a rechargeable battery and safety guidelines must be followed in the event that the product is disabled for disposal and recycling. To safely remove the battery for disposal and recycling, follow the numbered steps with the below diagrams.

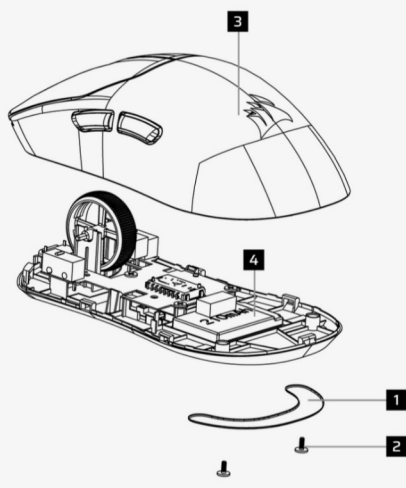

CORSAIR MEMORY, Inc. encourages customers to recycle used electronic hardware and rechargeable batteries in accordance with local laws and regulations.

For optimal performance, use this product within a temperature range of 5°C to 40°C (41°F to 104°F).

BATTERY INFORMATION

- M/N(型號): TW 302535
- Rating(電壓電流): 5V --- 250mA
- Scan QR code for battery detail information



Mouse
M/N(型號): RGP0183
Rating(電壓電流): 5V --- 250mA

Dongle
M/N(型號): RGP0185
Rating(電壓電流): 5V --- 50mA

CH-931G000-WW (Black)
CH-931G001-WW (White)
FCC ID: 2AAF-M-RGP0183 (Mouse)
FCC ID: 2AAF-M-RGP0185 (Dongle)
IC: 10954A-RGP0183 (Mouse)
IC: 10954A-RGP0185 (Dongle)



The power delivered by the charger must be between min 2.5 Watts required by the radio equipment, and max 10 Watts in order to achieve the maximum charging speed.

COPYRIGHT/LEGAL INFORMATION

© 2025 CORSAIR MEMORY, Inc. All rights reserved. CORSAIR and the sails logo are registered trademarks of CORSAIR in the United States and/or other countries. All other trademarks are the property of their respective owners. Product may vary slightly from those pictured.



RELATED CONTENT

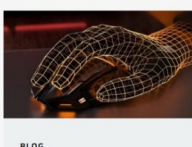

BLOG
MOUSE GRIPS EXPLAINED: FINGERTIP VS PALM VS CLAW



BLOG
SABRE V2 PRO: CORSAIR'S LIGHTEST, FASTEST WIRELESS GAMING MOUSE YET



BLOG
THE MANY BENEFITS OF AN ULTRALIGHT MOUSE

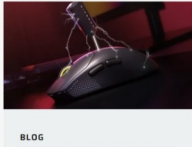

BLOG
SABRE V2 PRO: THE FIRST CORSAIR V2 PRO: THE FIRST WIRELESS 8K HZ POLLING



BLOG
VANGUARD 96, VANGUARD PRO 96, AND SABRE V2 PRO: iCUE COMING SOON!

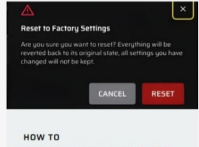

HOW TO
CORSAIR WEB HUB: HOW TO FACTORY DEVICE