



RAZER BLACKSHARK V3 FOR XBOX

MASTER GUIDE

CONTENTS

1. WHAT'S INSIDE2

2. WHAT'S NEEDED4

3. LET'S GET YOU COVERED.....4

4. GETTING STARTED.....5

5. USING YOUR RAZER BLACKSHARK V311

6. CONFIGURING YOUR RAZER HEADSET.....23

7. SAFETY AND MAINTENANCE39

8. LEGALESE.....40

1. WHAT'S INSIDE

- Razer BlackShark V3 For Xbox

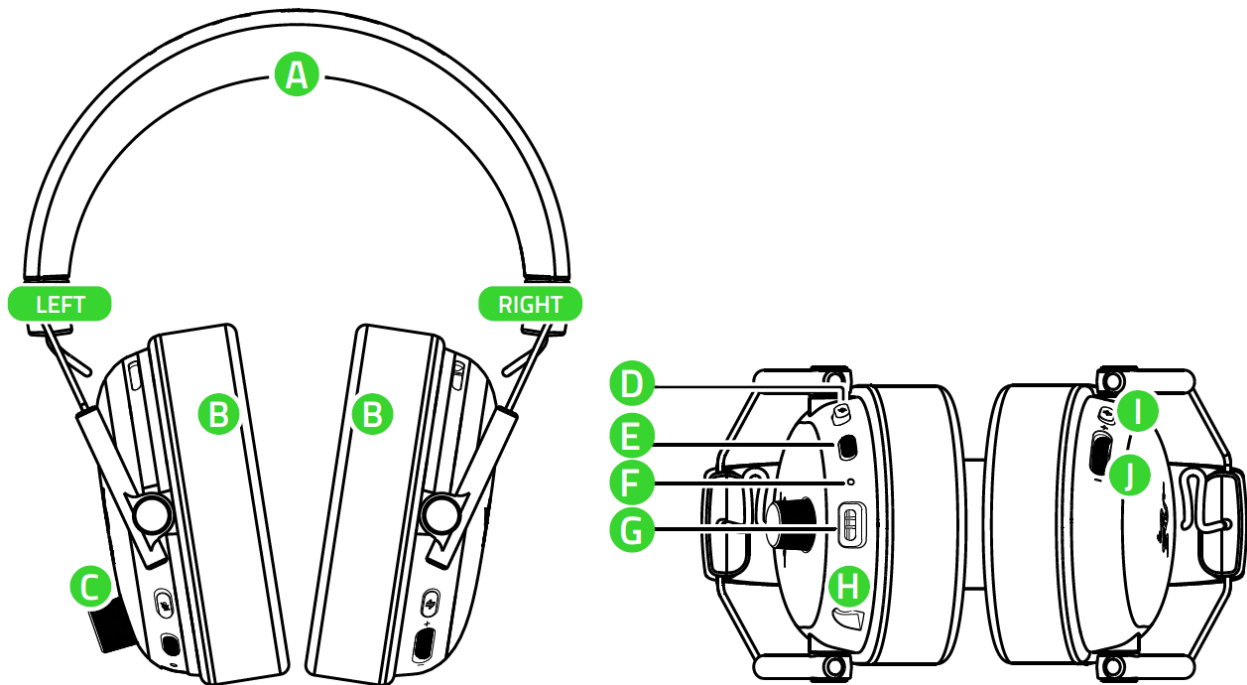

- A. Adjustable padded headband
- B. Dual-layered Flowknit memory foam cushions
- C. Volume control
- D. Mic mute toggle
- E. Power button
- F. Status indicator
- G. USB Type C port
- H. Microphone port
- I. SmartSwitch button
 - Equalizer (EQ) Presets*
 - 2.4GHz Mode
 - Bluetooth® Mode
 - Simultaneous Audio Mode
- J. Configurable Game/Chat balance control*

- Razer™ HyperSpeed Wireless Gen-2 Dongle

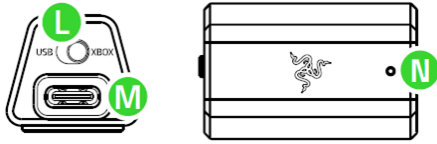

K. Headset mode switch

L. USB Type C port

M. Dongle indicator LED

- Detachable Razer™ HyperClear Full Band 12mm Mic

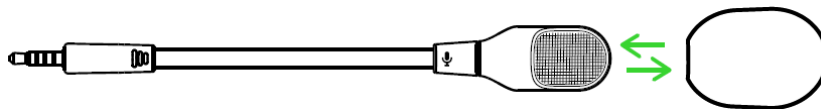

- Type A to Type C cable

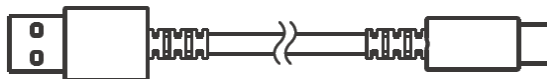

- Important Product Information Guide

**Customizable to other functions via Razer Audio Setup for Xbox, Razer Synapse, or Razer Audio App*

2. WHAT'S NEEDED

PRODUCT REQUIREMENTS

- Devices with Bluetooth audio capability or USB Type A port

RAZER SYNAPSE REQUIREMENTS

- Windows 10 64-bit (or higher)
- Internet connection for app installation

RAZER AUDIO APP REQUIREMENTS

- Xbox Series™ X|S
- iOS 12 / Android 8.1 Oreo (or higher)
- Internet connection for app installation

3. LET'S GET YOU COVERED

Your product's serial number can be found here.

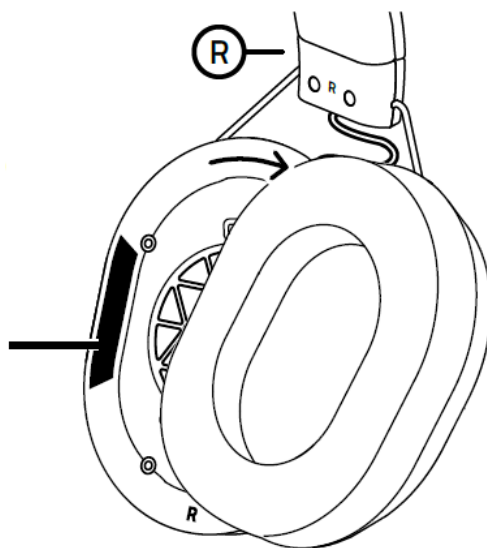

Register your product and score exclusive benefits

[razerid.razer.com/warranty](https://www.razerid.razer.com/warranty)

4. GETTING STARTED

CHARGE YOUR HEADSET

1

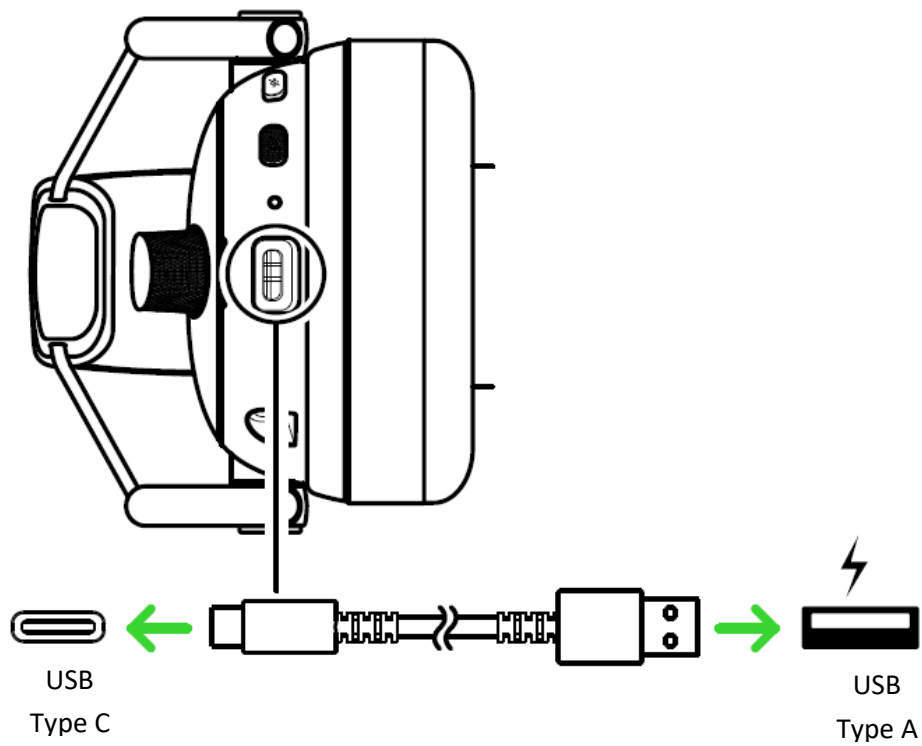

2

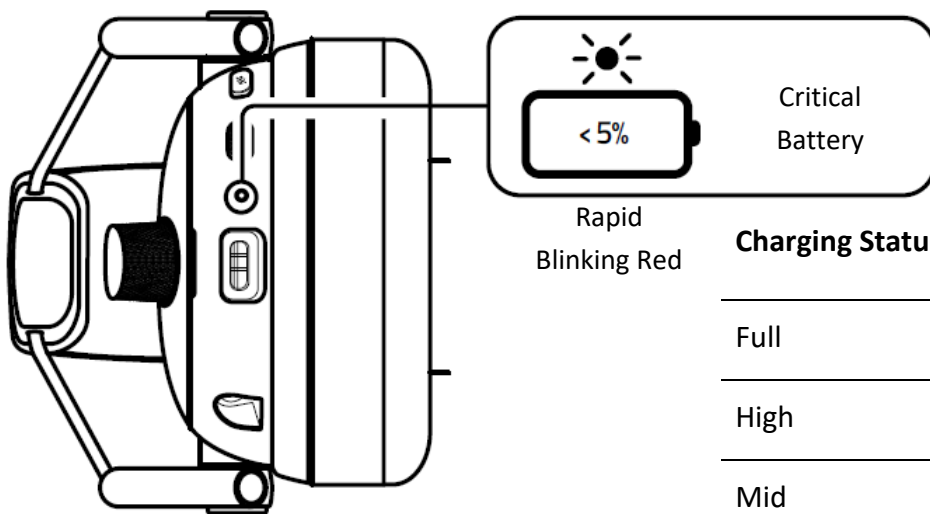

Charging Status	Status Indicator
Full	Static Green
High	Blinking Green
Mid	Blinking Yellow
Low	Blinking Red



For best results, connect your Razer BlackShark V3 For Xbox directly to your computer's USB port using the provided cable. A depleted battery will be fully charged in approximately 4 hours. You

can charge the headset using the USB-C cable that comes with your official Xbox controller if the included cable is currently in use by the dongle.

POWER YOUR HEADSET ON/OFF

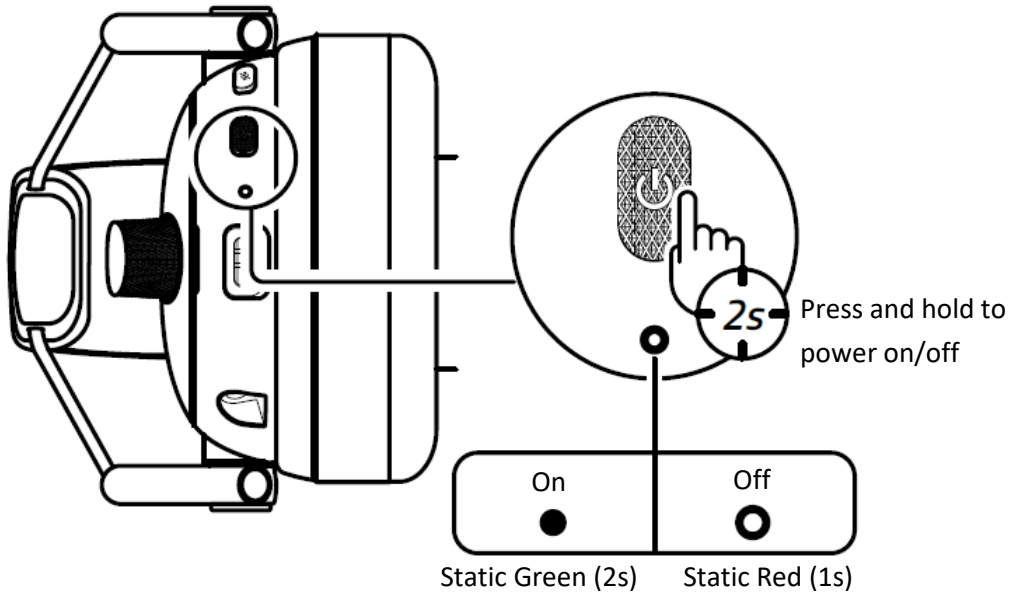

CONNECT TO YOUR DEVICE

WIRED MODE

For Xbox

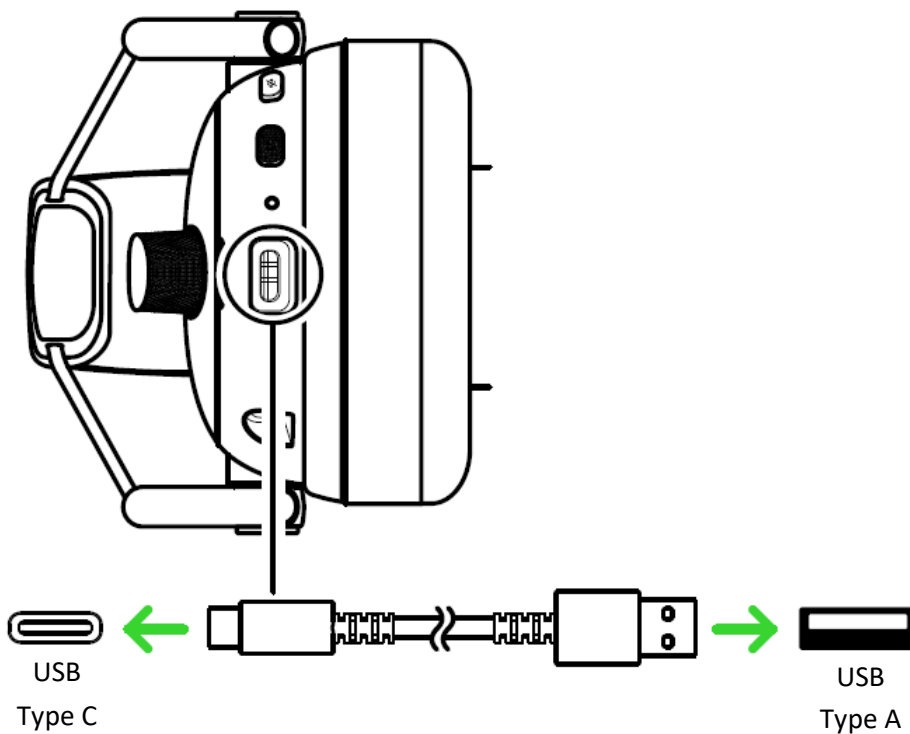

2.4GHz MODE

For Xbox

1

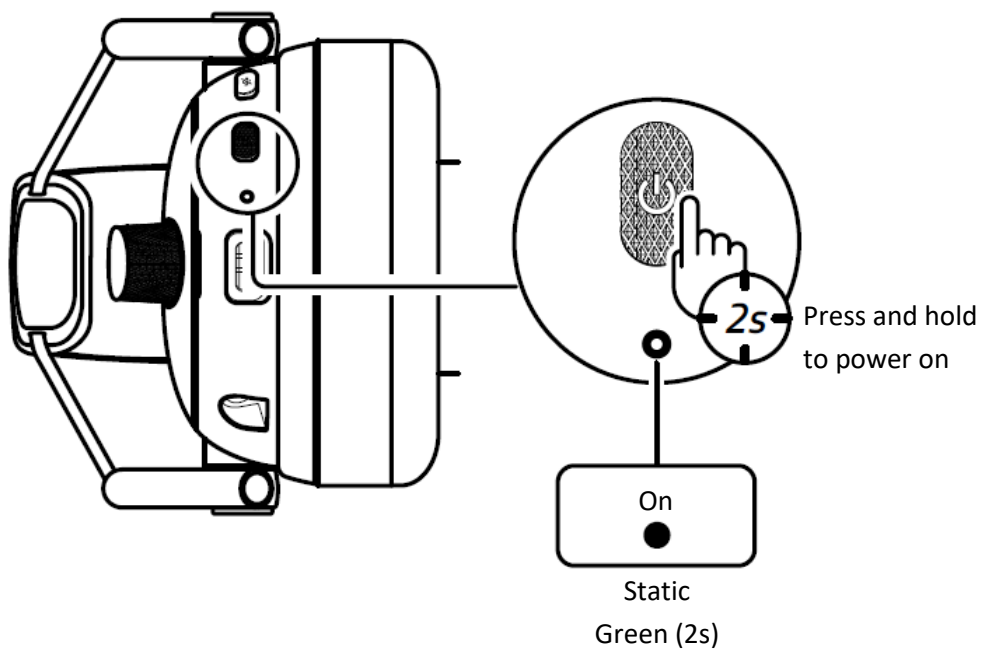

2

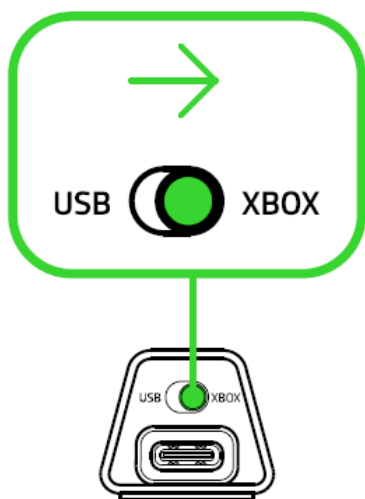

3

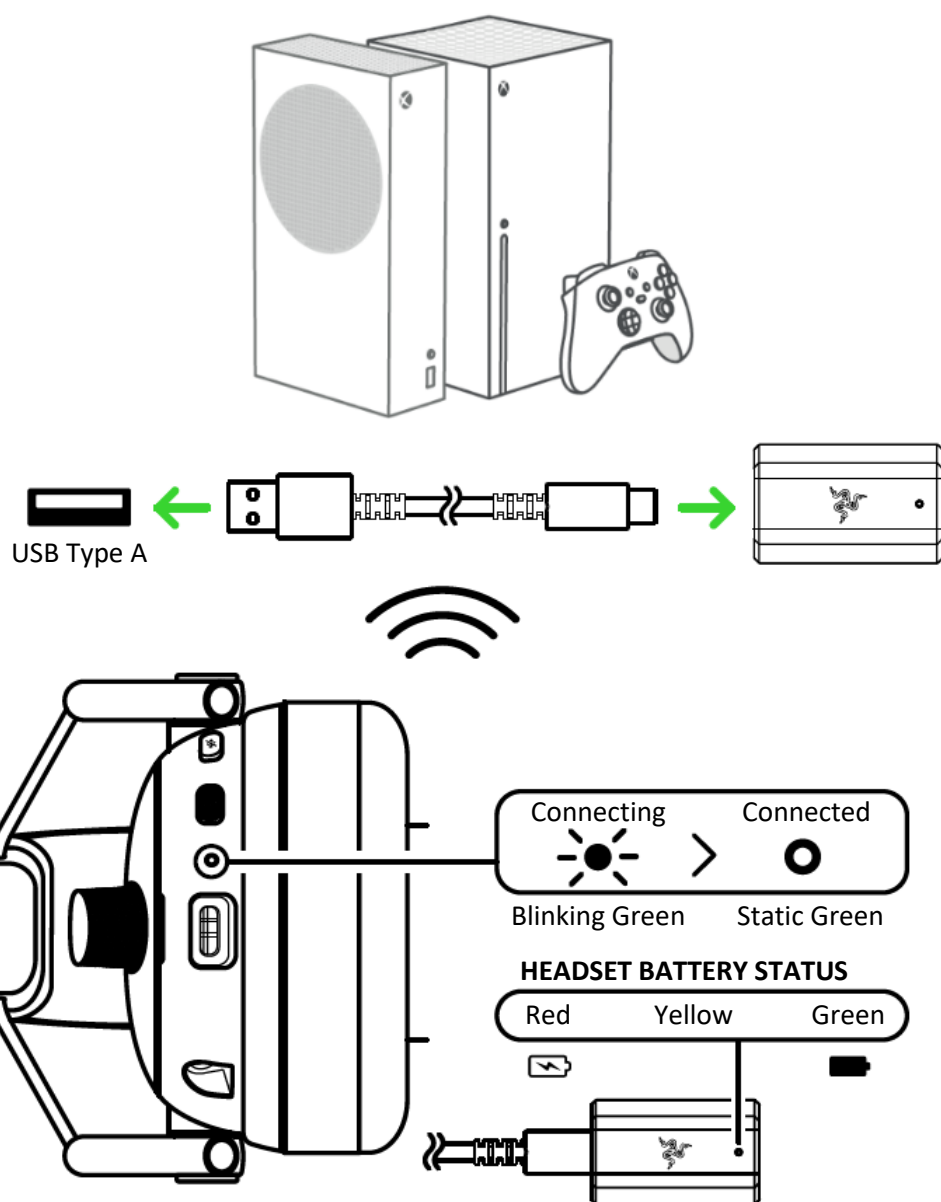

i Customize the LED indicator to show the headset's connection status, battery status (default) or low battery warning using Razer Audio Setup for Xbox app.

For PC

1

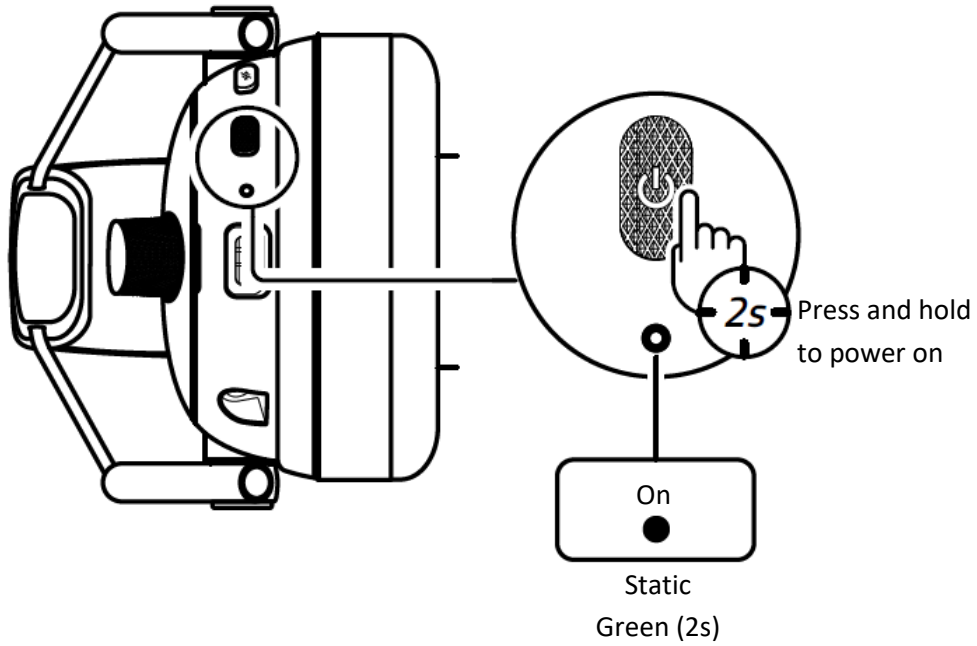

2

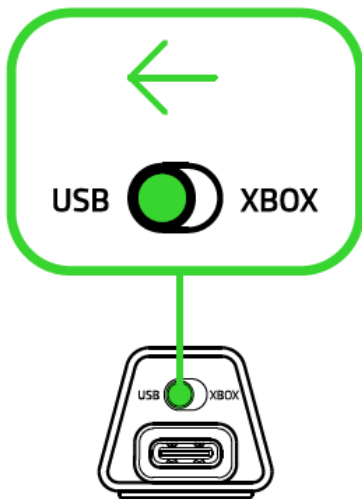

3

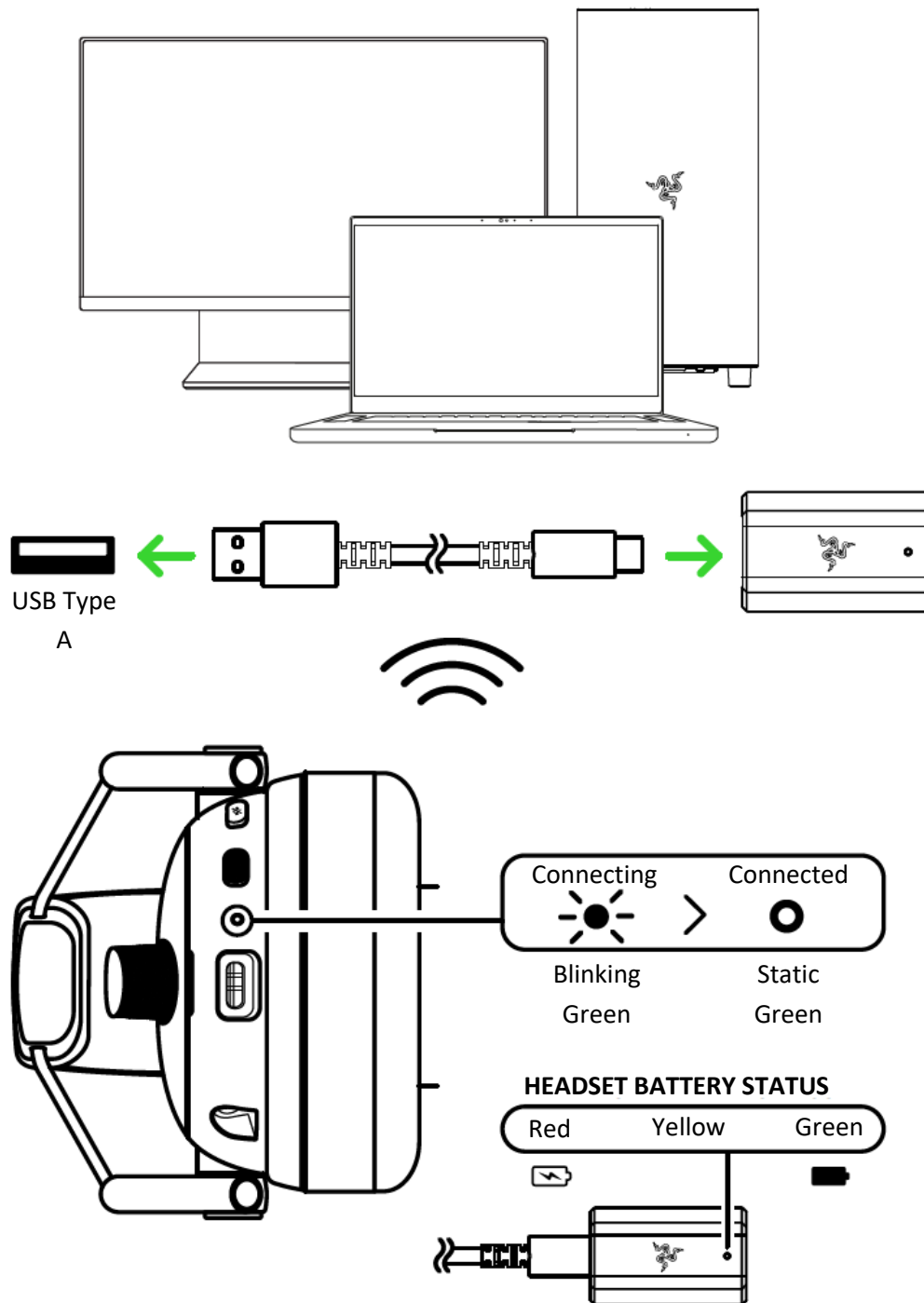

Customize the LED indicator to show the headset's connection status, battery status (default) or low battery warning using Razer Synapse.

BLUETOOTH® MODE

1

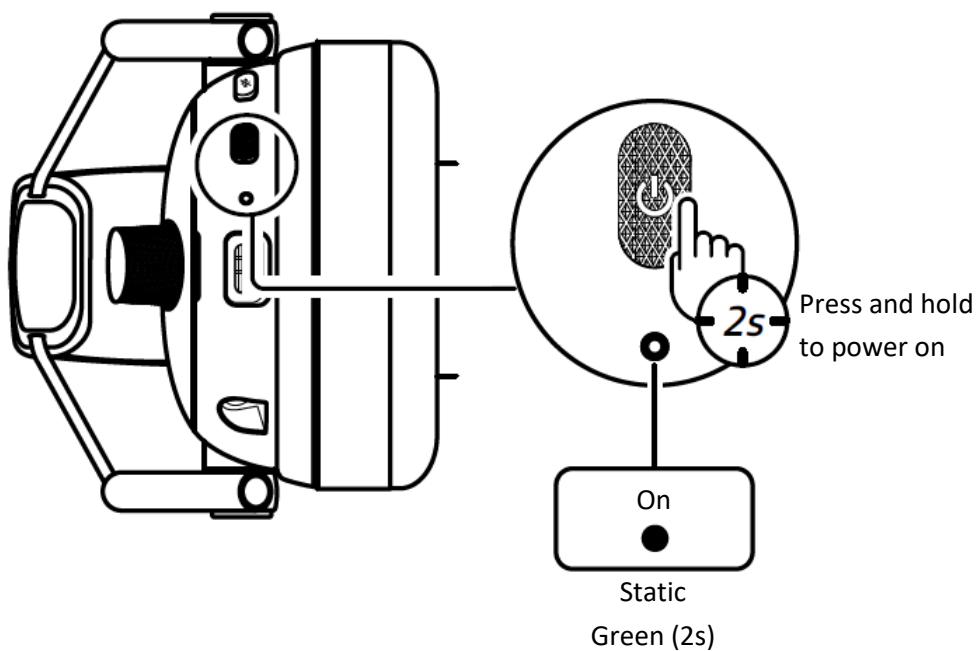

2

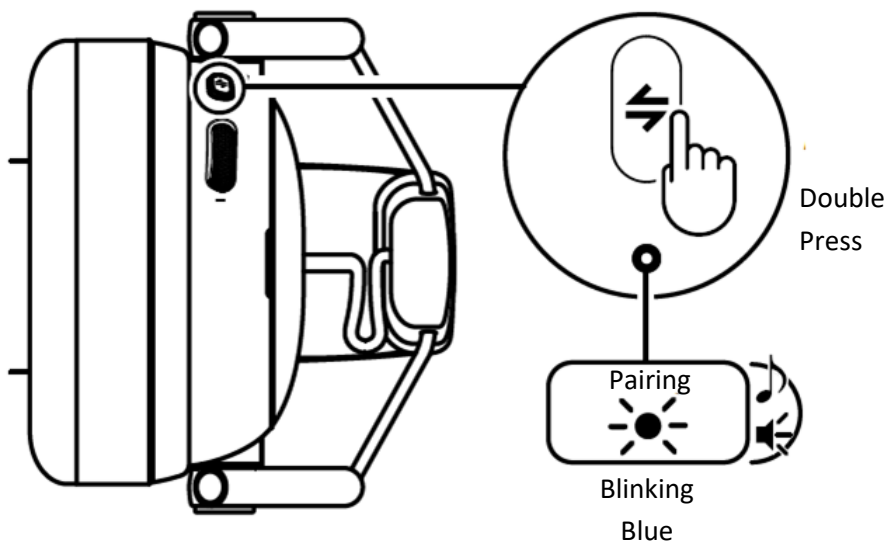

3

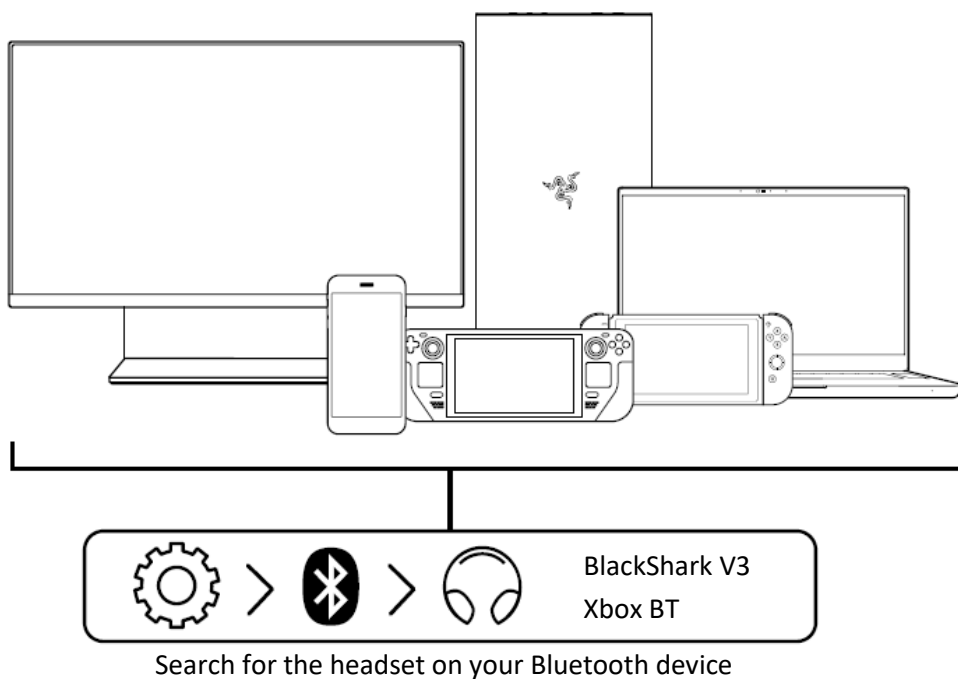

4

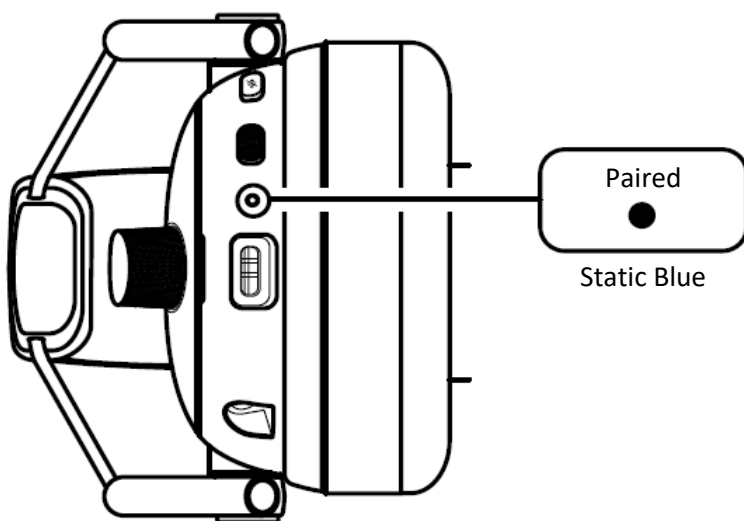

i If pairing times out and the headset powers off, follow the next procedure to reinitiate pairing.

Reactivating Bluetooth Pairing Mode

1

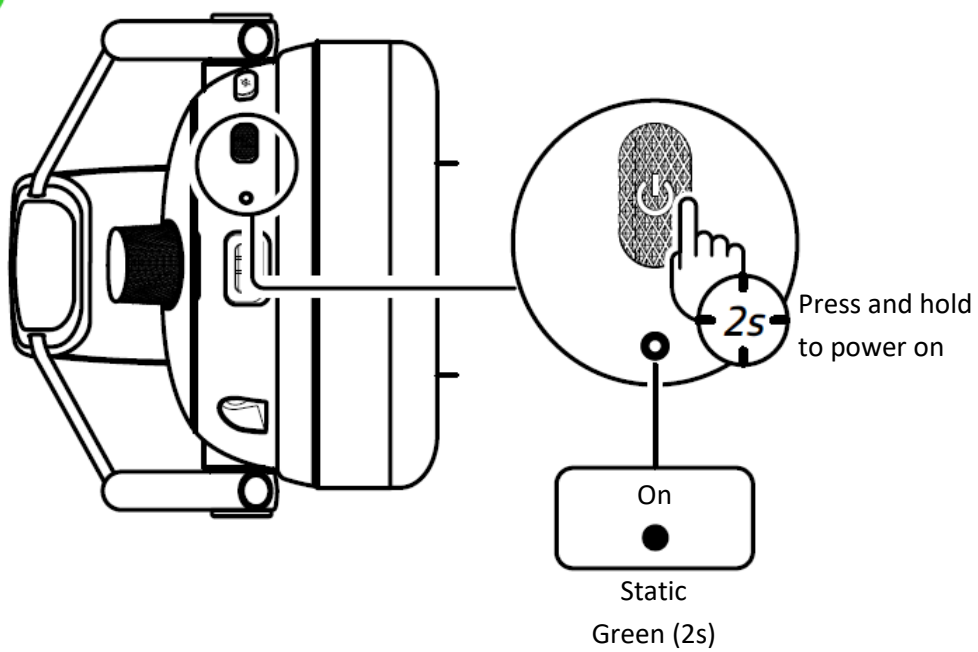

2

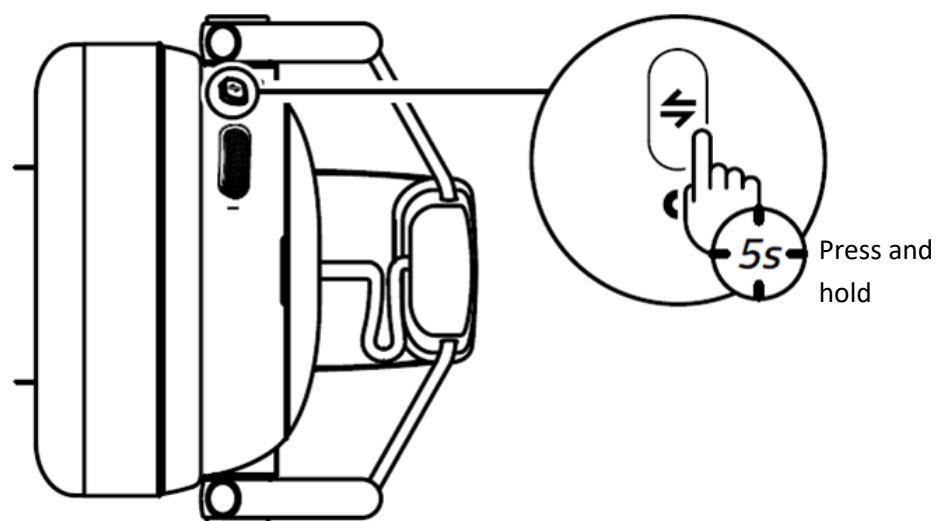

3

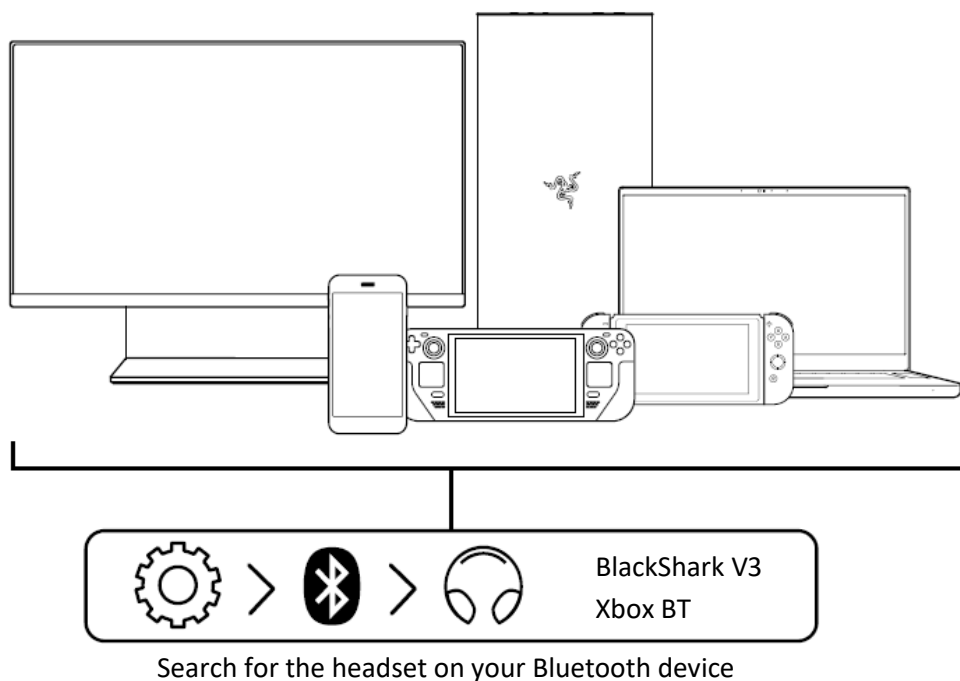

4

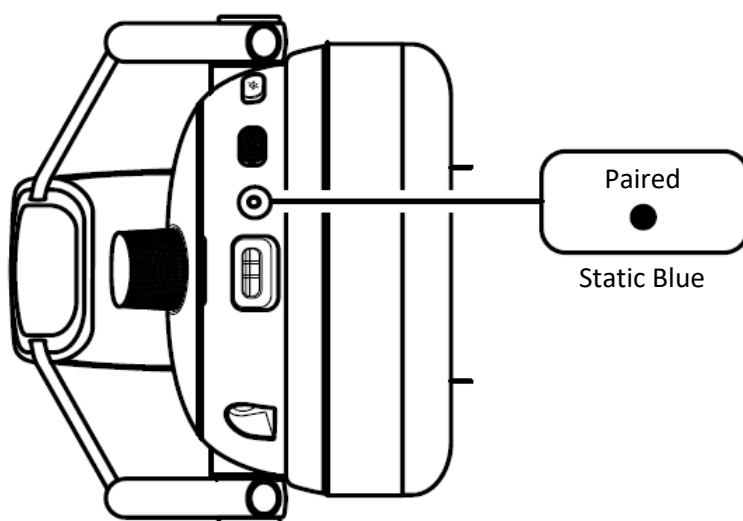

PAIRED TO BOTH WIRELESS MODES

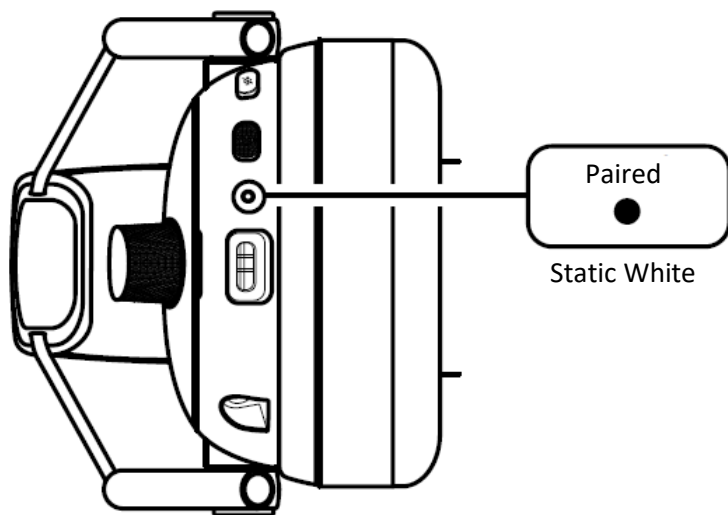

CYCLE THROUGH WIRELESS MODES

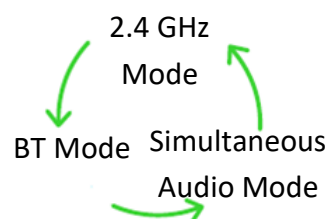
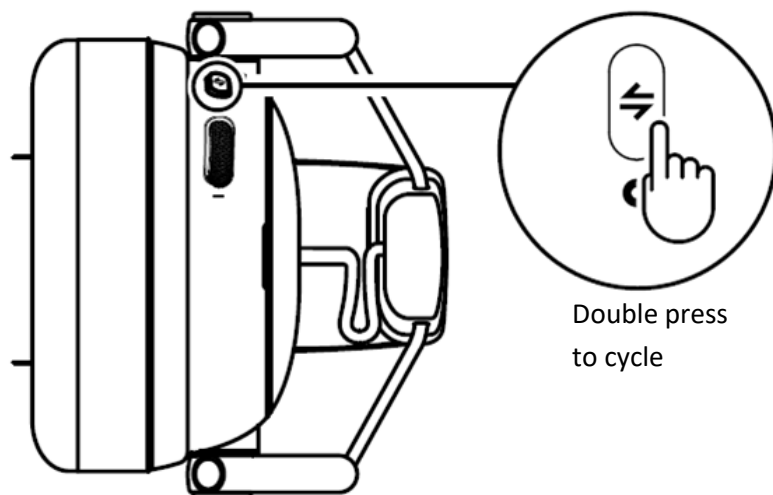

ADDITIONAL SETUP

FOR XBOX

Customize your headset and access other advanced features for a phenomenal audio experience that's genuinely yours. Download and install the Razer Audio Setup for Xbox app from the Microsoft Store on your Xbox console.



Razer Audio Setup
For Xbox

FOR PC

Make sure to set the Razer BlackShark V3 For Xbox as your PC's default input and output device.

Wired Mode

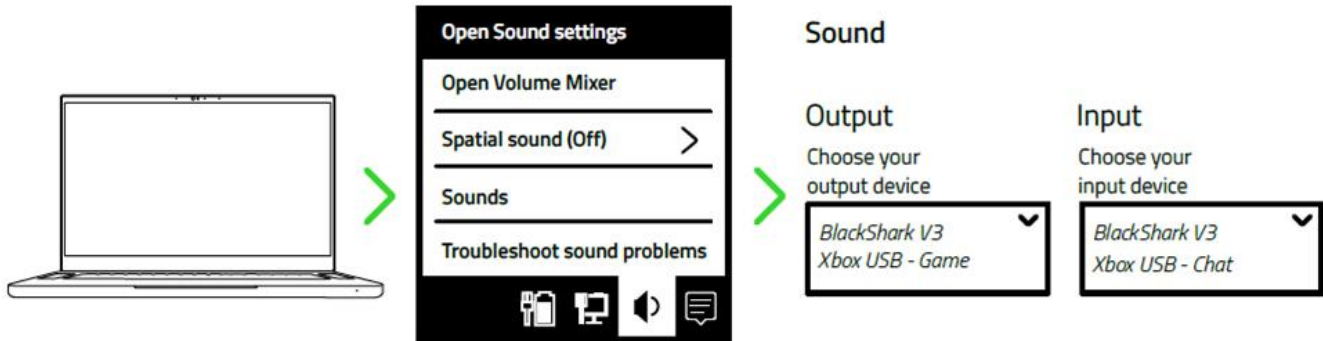

2.4GHz Mode

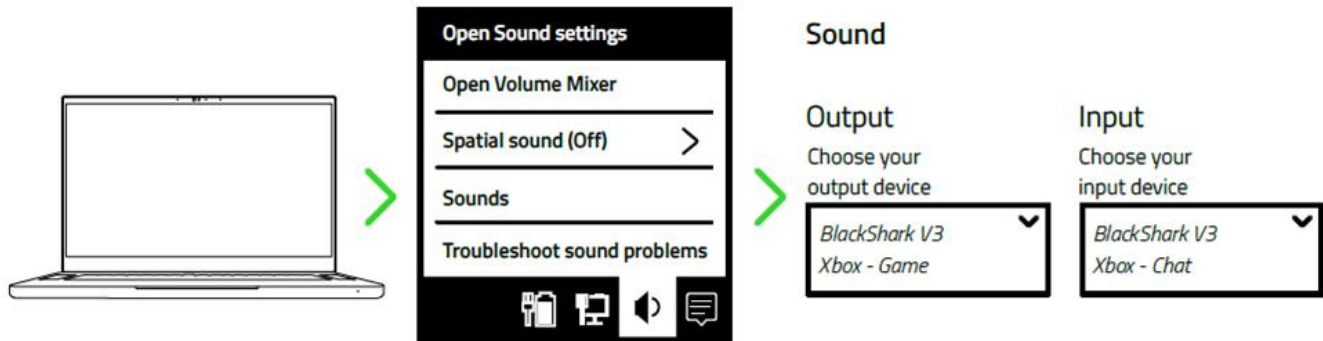

Personalize your PC experience

Use the Razer Synapse app to customize your headset's EQ, enable audio enhancements, and fine-tune other advanced features. Install Razer Synapse when prompted, or download the installer from razer.com/synapse

Activate THX® Spatial Audio*

Unleash the full potential of your Razer BlackShark V3 For Xbox by enabling 360° positional audio for a natural and lifelike experience through Razer Synapse.



**Only available on Windows 10 64-bit and above.*

FOR MOBILE

Download the Razer Audio App to customize your headset's EQ settings, auto shutoff feature, gaming mode, and much more — anytime, anywhere.



1. Download the mobile app on your mobile device.
2. Launch the app and follow the onscreen instructions.

 *When using the Razer Audio app, ensure the headset is connected to your mobile device via Bluetooth.*

5. USING YOUR RAZER BLACKSHARK V3

RAZER HYPERCLEAR FULL BAND MIC

PLUG IN THE MIC

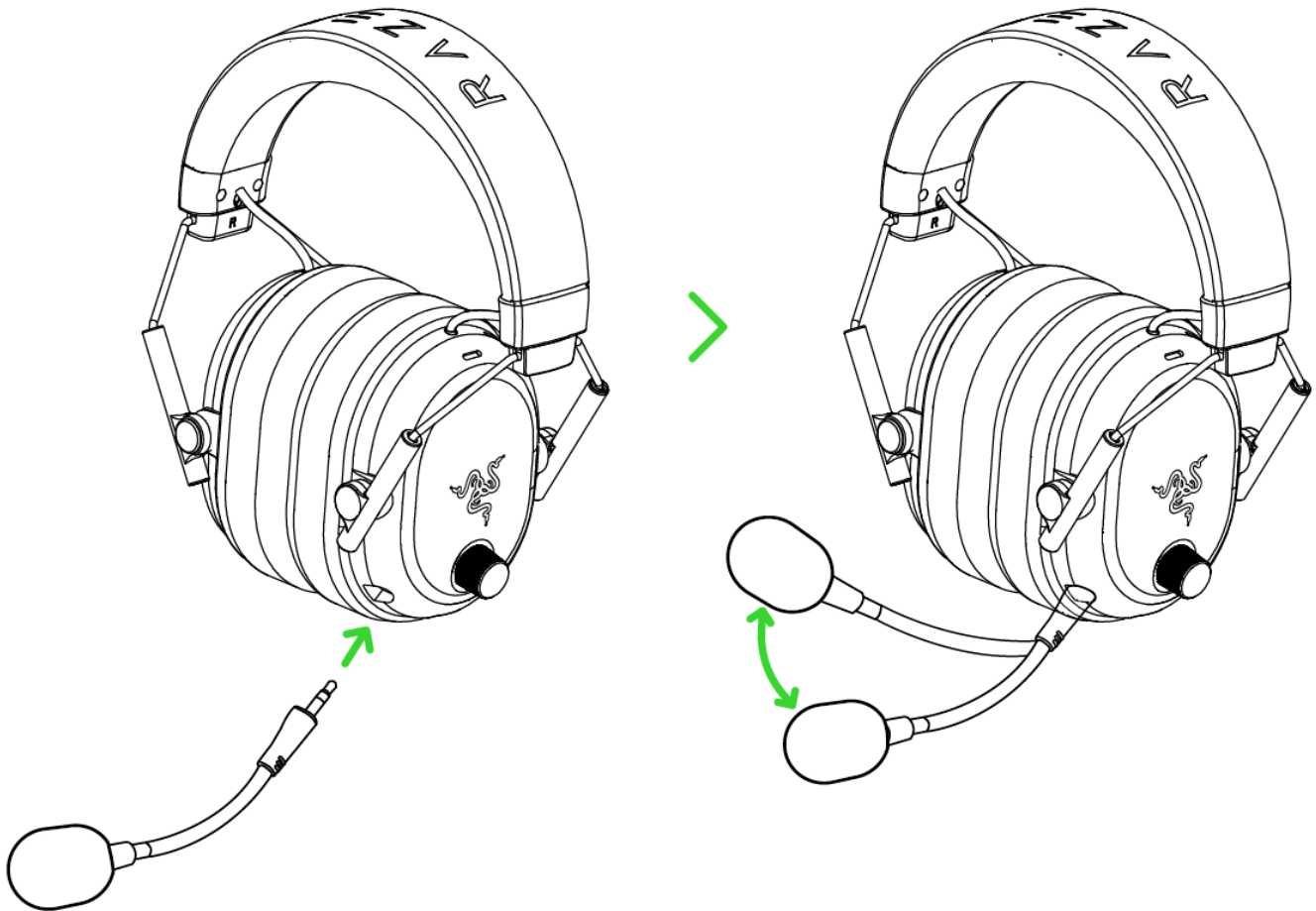

PROPER MIC PLACEMENT

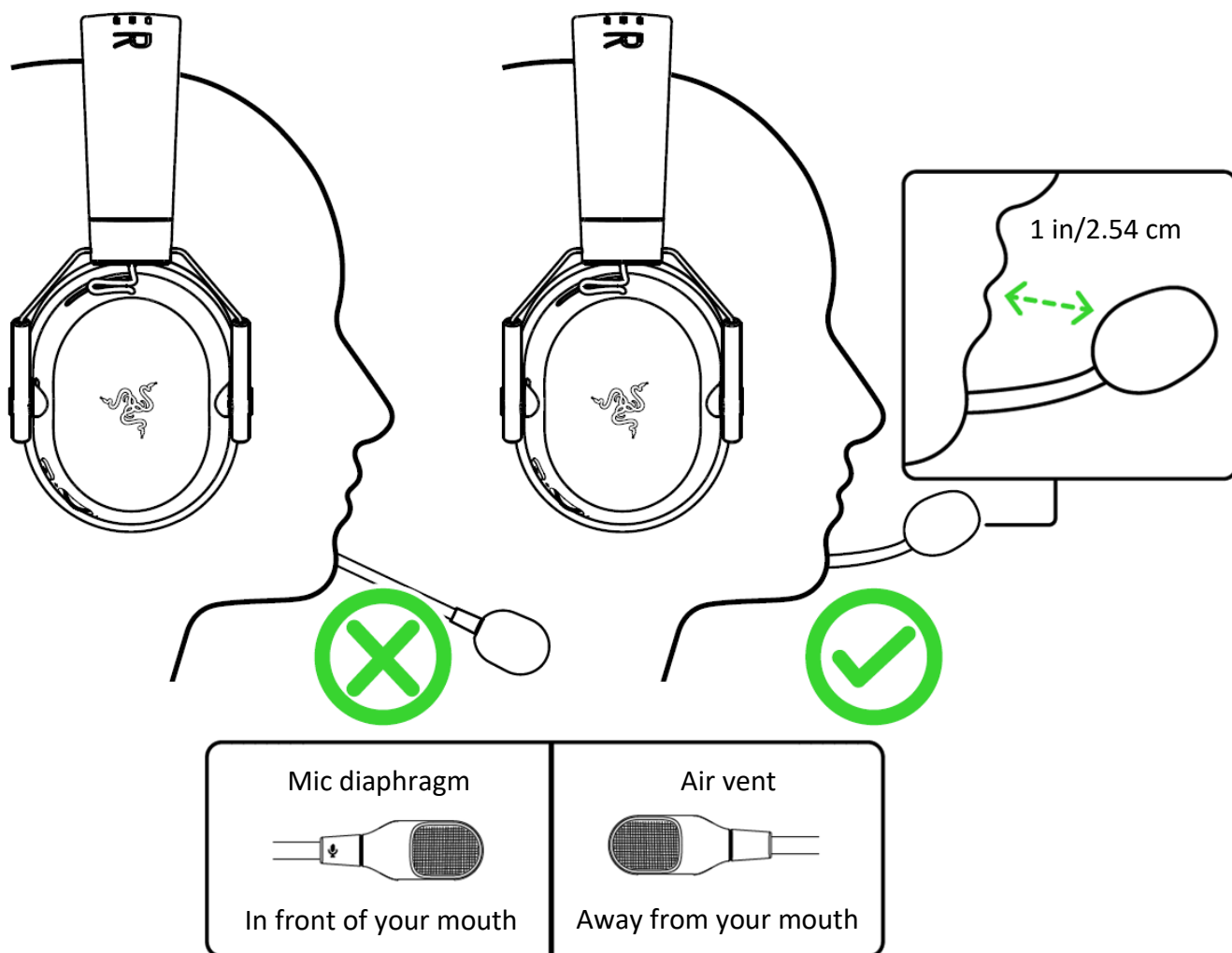

SET THE MIC TO MUTE/UNMUTE

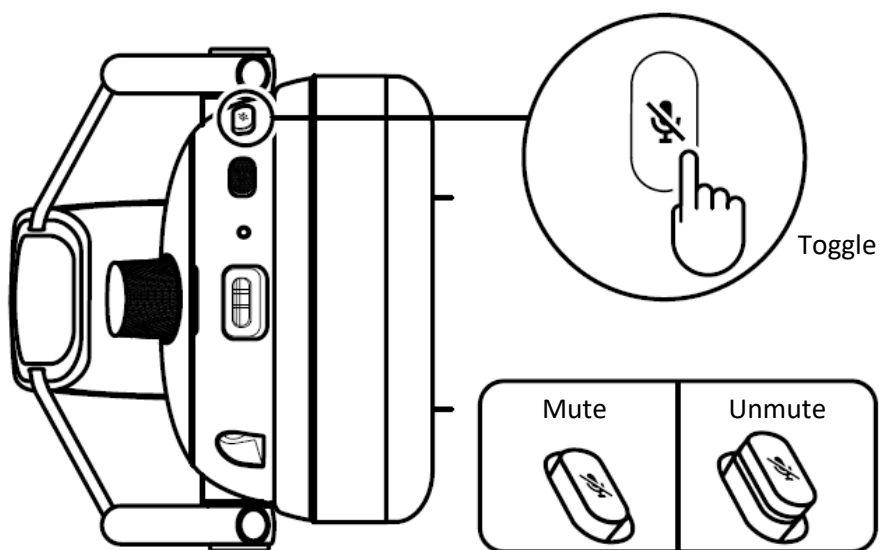

CHANGE THE VOLUME

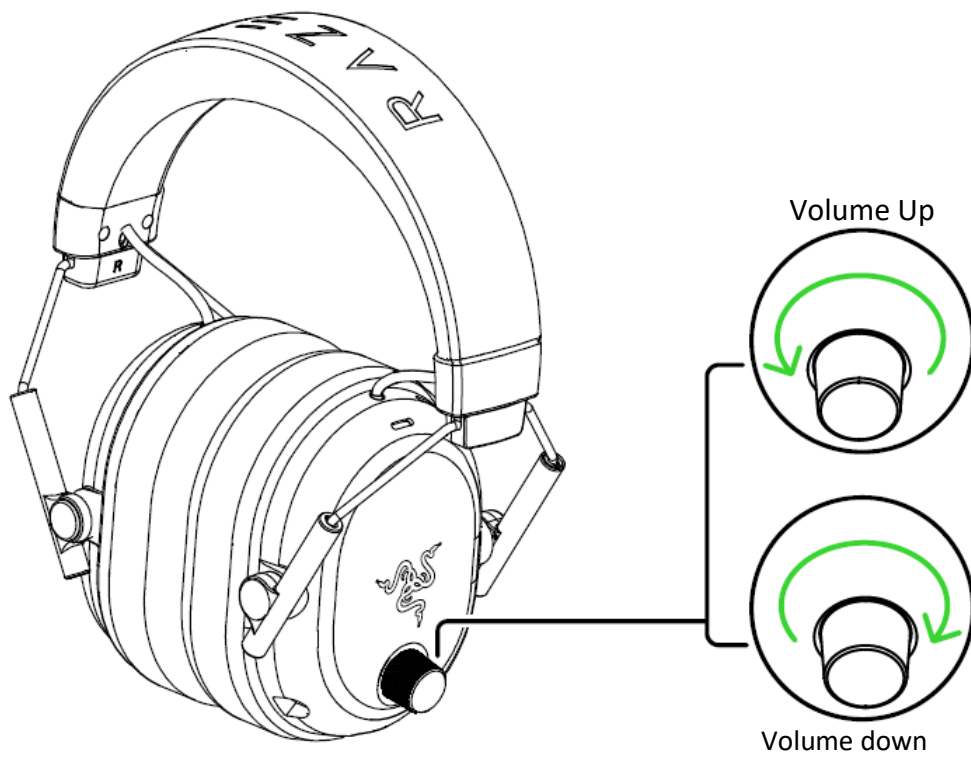

SWITCH EQ PRESETS

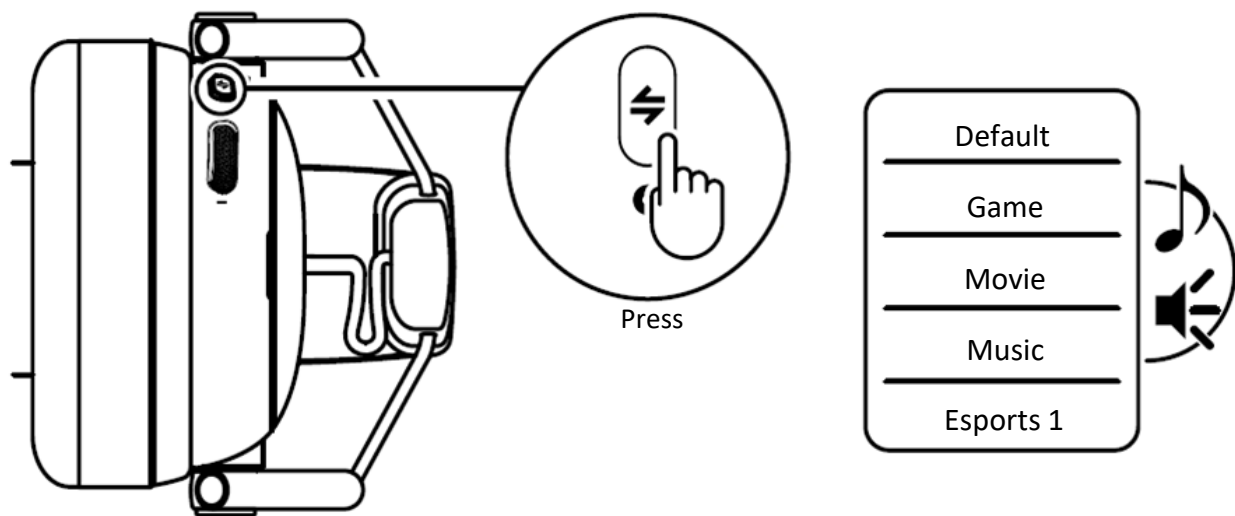

i EQ Preset list can be modified via Razer Audio Setup for Xbox, Razer Synapse, or Razer Audio App

CHANGE THE GAME/CHAT BALANCE

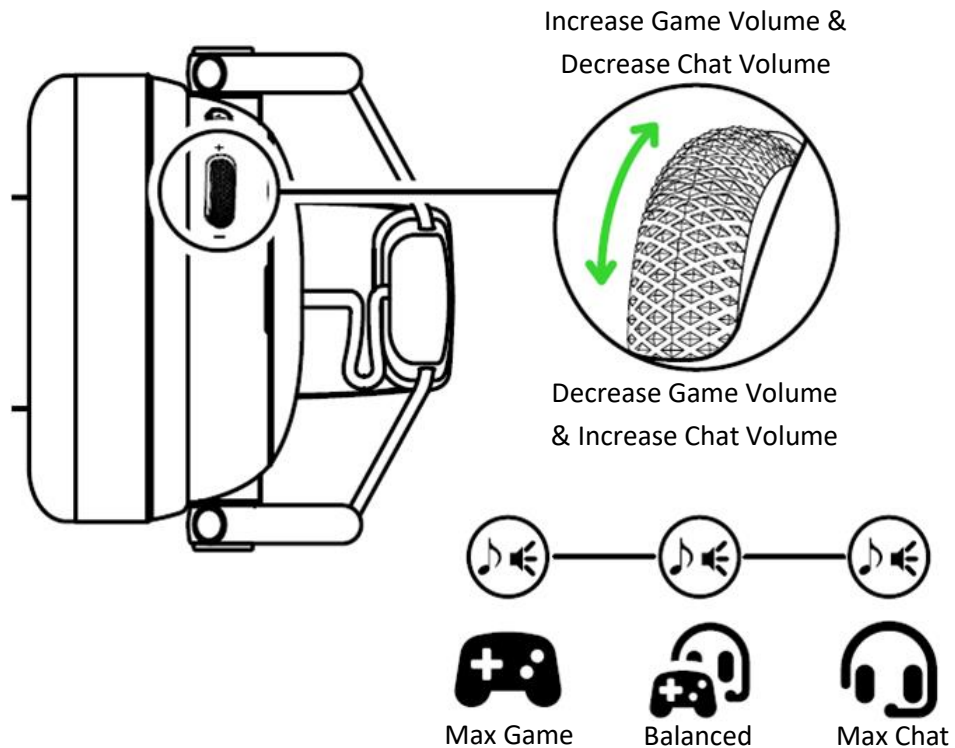

i Customizable to other functions via Razer Audio Setup for Xbox, Razer Synapse, or Razer Audio App

BLUETOOTH CALL FUNCTION REFERENCE

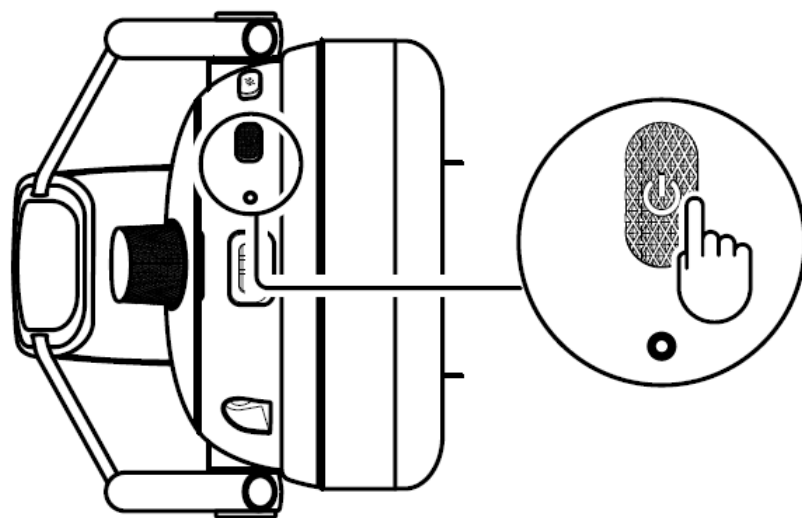

Action	Call Status	Effect
Single press	Incoming call	Accept an incoming call
	Active call	End the current call
	Active primary call and incoming secondary call	Put a call on hold and accept an incoming call
	Active primary call and secondary call on hold	End call and swap to on-hold call
Double press	Incoming call	Reject incoming call
	Active primary call and incoming secondary call	Reject incoming secondary call
	Active primary call and secondary call on hold	Switch between calls

ADJUST FOR COMFORT

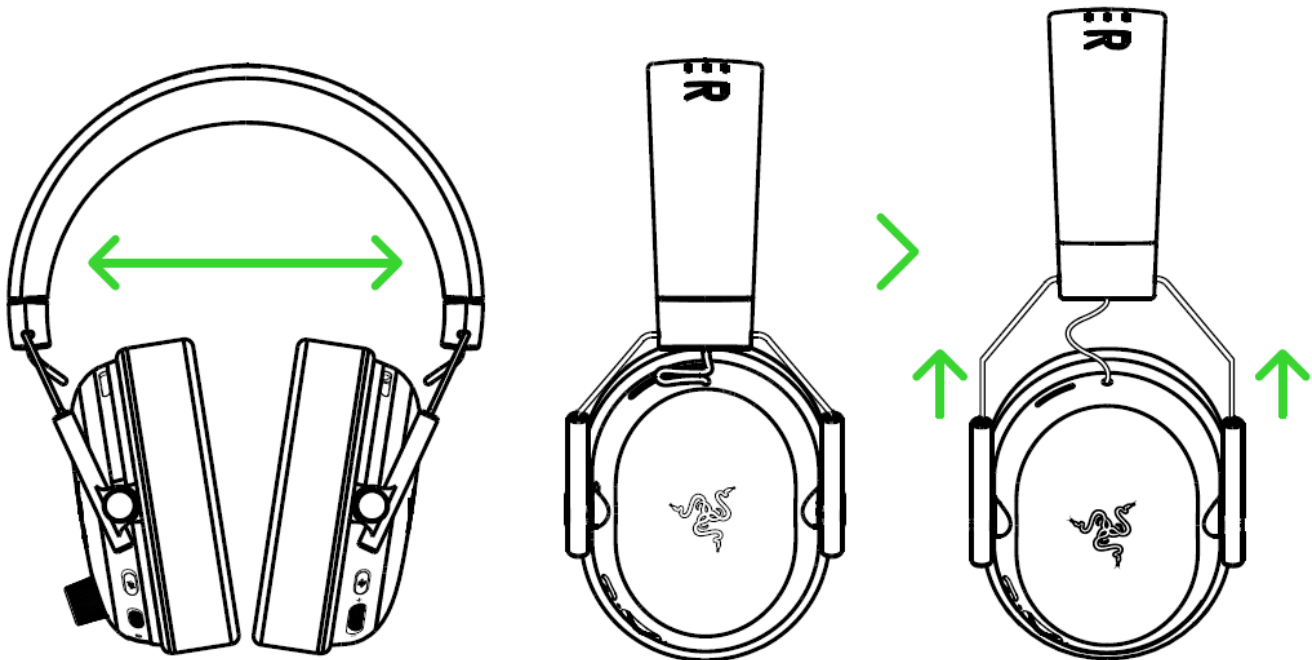

i Gently stretch the headbands before wearing the headset but do not overstretch it to avoid permanent damage.

Find out more about your gaming-grade headset at support.razer.com

6. CONFIGURING YOUR RAZER HEADSET

 *Disclaimer: This guide provides an overview of the New Razer Synapse app and may only partially cover some of the features of your device. The New Razer Synapse requires an Internet connection to install, update, access, and save cloud-based features. Registering for a Razer ID account is recommended but optional. All features listed here are subject to change based on the current version, connected device(s), and supported add-ons.*

SYNAPSE

The Synapse tab is your default tab when you first launch Razer Synapse. Use the following buttons below to navigate the user interface:

— Minimize

Clicking this button will minimize the app to the taskbar while it runs in the background.

□ Maximize

This button expands the browser window to fill the entire screen. To restore the window to its original size, click the maximize button again.

✕ Close

This button will close all relevant tabs and terminate the application completely.

◀ Previous Tab

Clicking this button will return you to the last tab you have visited.

➤ Next Tab

Clicking this button will move you to the next page if you've recently used the Previous Tab button.

↻ Refresh Tab

This button reloads the current page. Use this if a page isn't displaying correctly or you want to see the latest content.

⬇ Download Update

If this button appears, that means there are changes to the app. Use this if a page isn't displaying correctly or you want to see the latest content.

More

Clicking this button will open a pop-up so you can easily access your Devices, Modules, and Other Installed Apps tabs.

Settings

Clicking this button will open the Settings tab, so you can quickly change the settings to this app.

Profile

This button will open a pop-up to access the Log In, Feedback, Rate This Software, Add WiFi Device, and Exit options.

Info

Hovering over this button will pop up an additional information about a feature or function.

Dashboard

The Dashboard subtab is an overview of your Razer Synapse, where you can access all your Razer devices, modules, and online services.

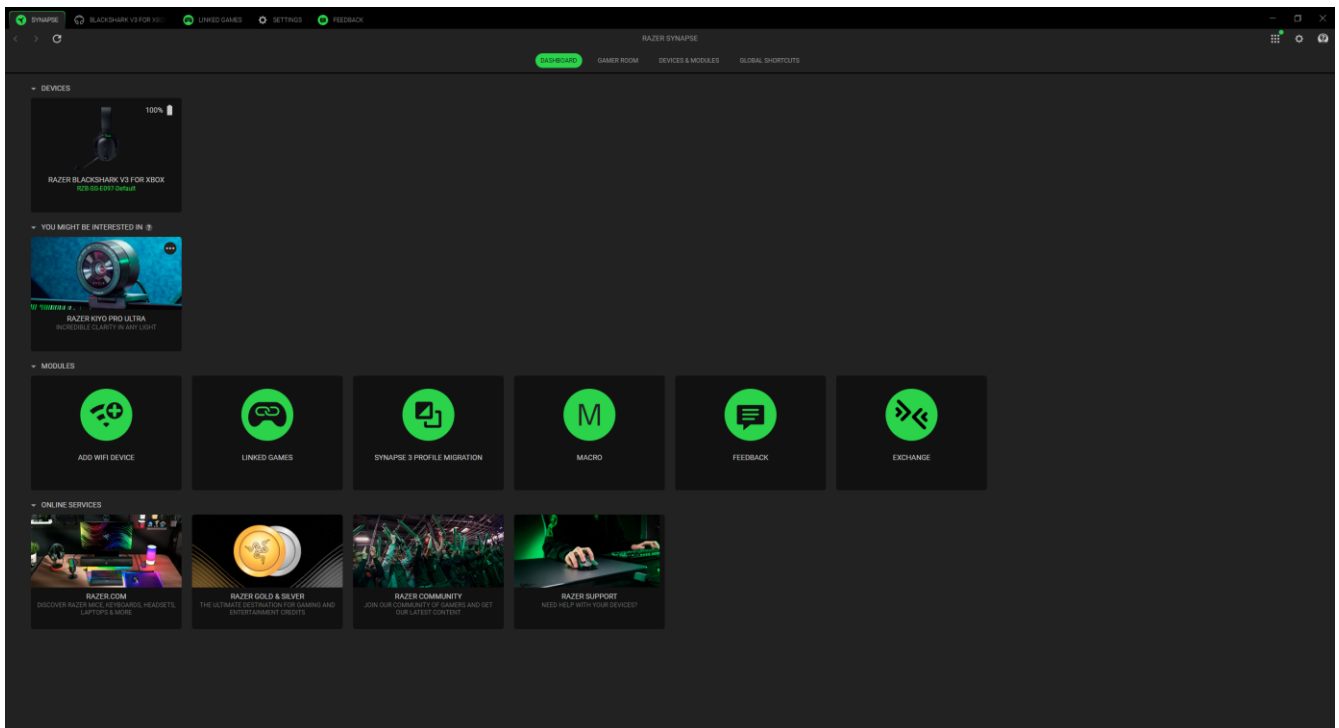

Gamer Room

The Gamer Room subtab shows all devices with the Razer Aether Light feature. From here, you can view and manage your Gamer Room-supported devices.

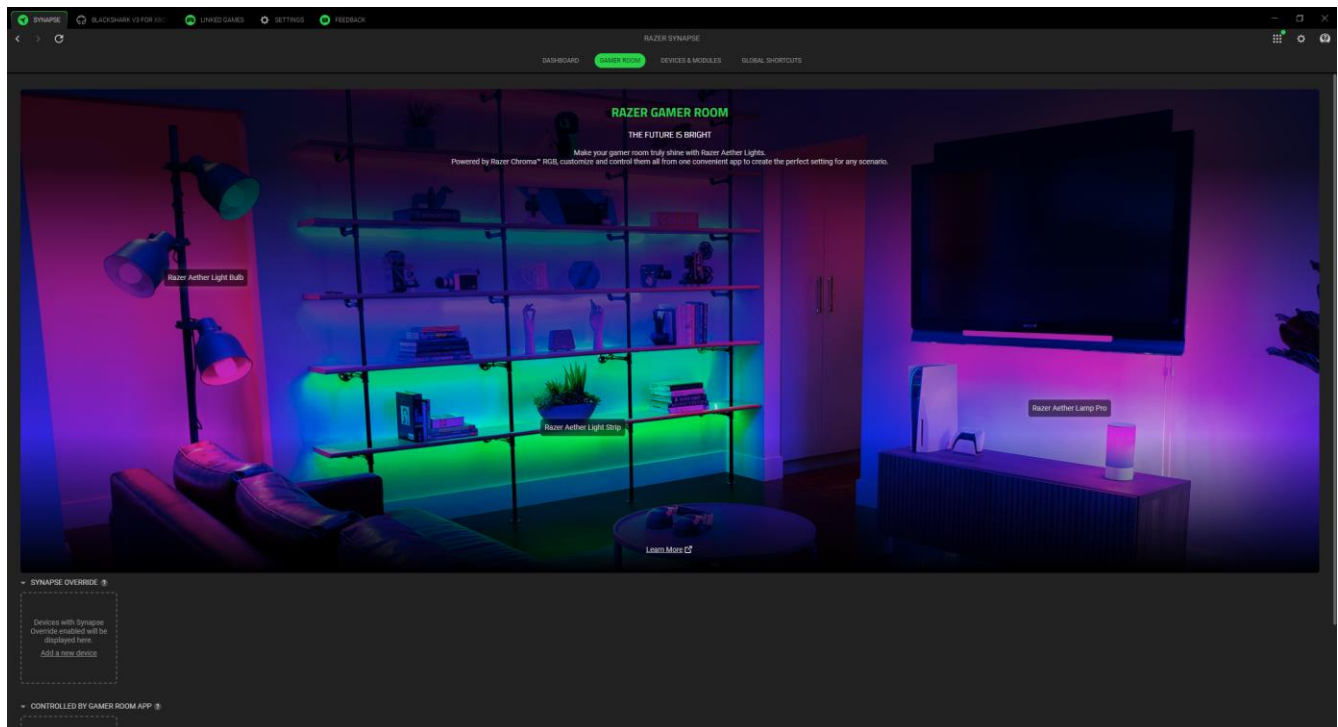

Synapse Override

This section allows you to select and customize your device's lighting and make it react to Chroma-enabled games and Chroma Connect apps using Razer Synapse.

Controlled By Gamer Room App

This section displays all supported devices controlled remotely by the Gamer Room app.

Devices & Modules

The Modules subtab displays all installed and available modules for installation.

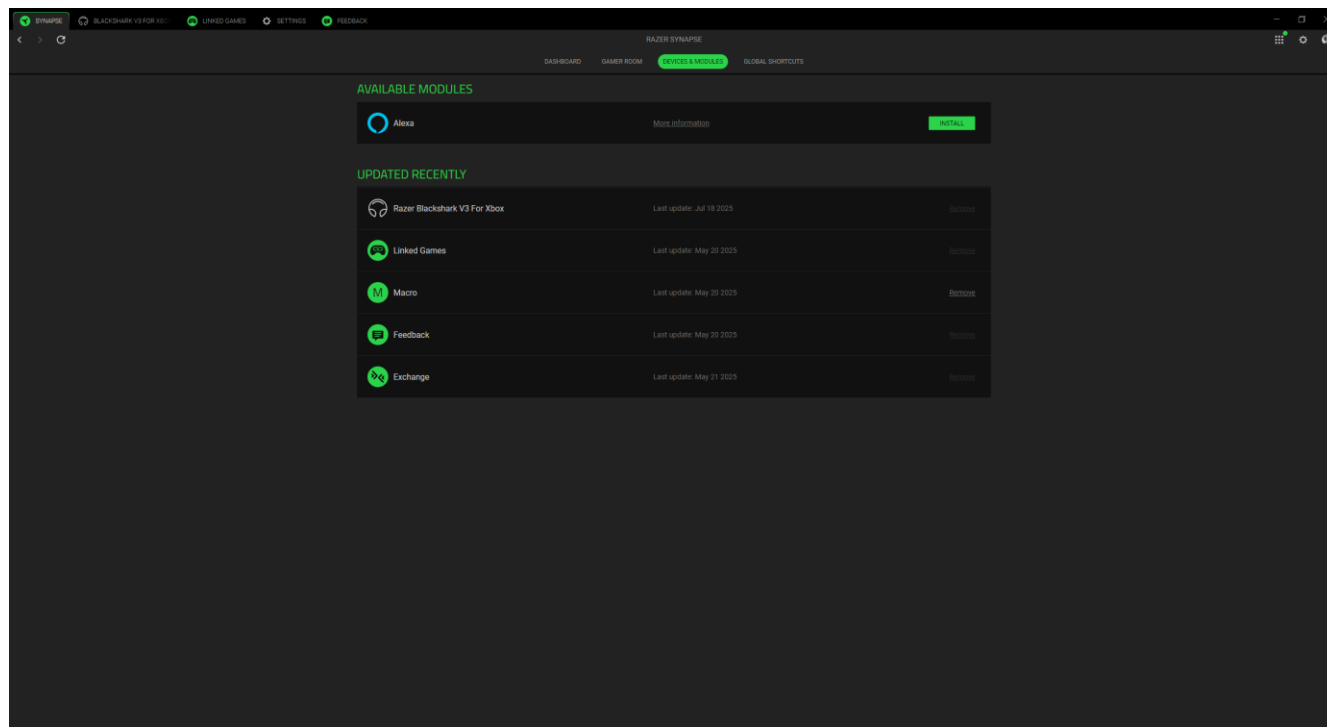

Global Shortcuts

Bind operations or Razer Synapse functions to custom key combinations from any Razer Synapse-enabled device inputs, which apply across all device profiles.

 *Only Razer Synapse-enabled device inputs will be recognized.*

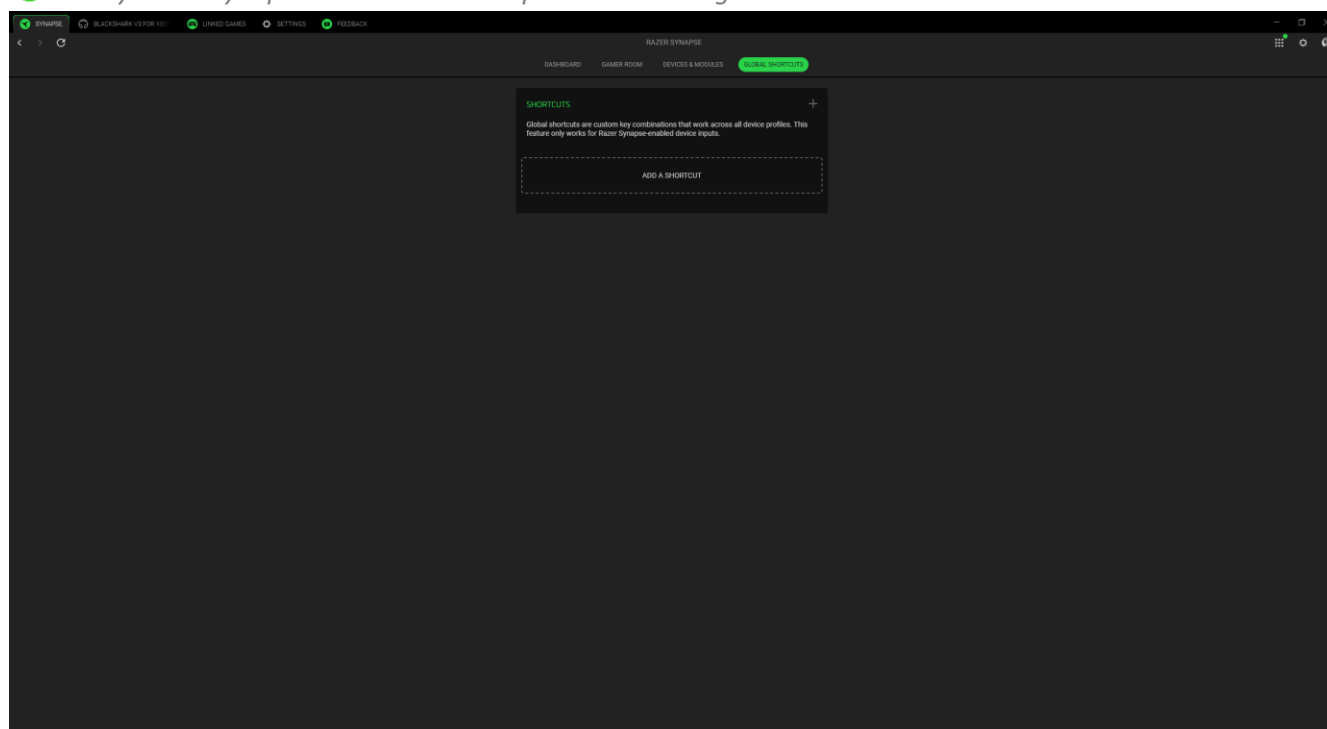

BLACKSHARK V3 FOR XBOX

The BlackShark V3 For Xbox tab is the main tab for your Razer headset. You can change your device settings from here, such as lighting (if supported), setting and customizing EQ profiles, and adjusting the overall system volume or individual volume of all active applications. Any changes under this tab will be saved automatically to your local system and cloud storage. Use the following buttons below to access your profile options:

 Profiles Dropdown Bar

Clicking this dropdown bar will display all the profiles for this device so you can quickly change profiles.

*** Miscellaneous

Clicking this button will open a pop-up with options related to your current profile.

Sound

The Sound subtab is for adjusting and modifying your device's audio settings.

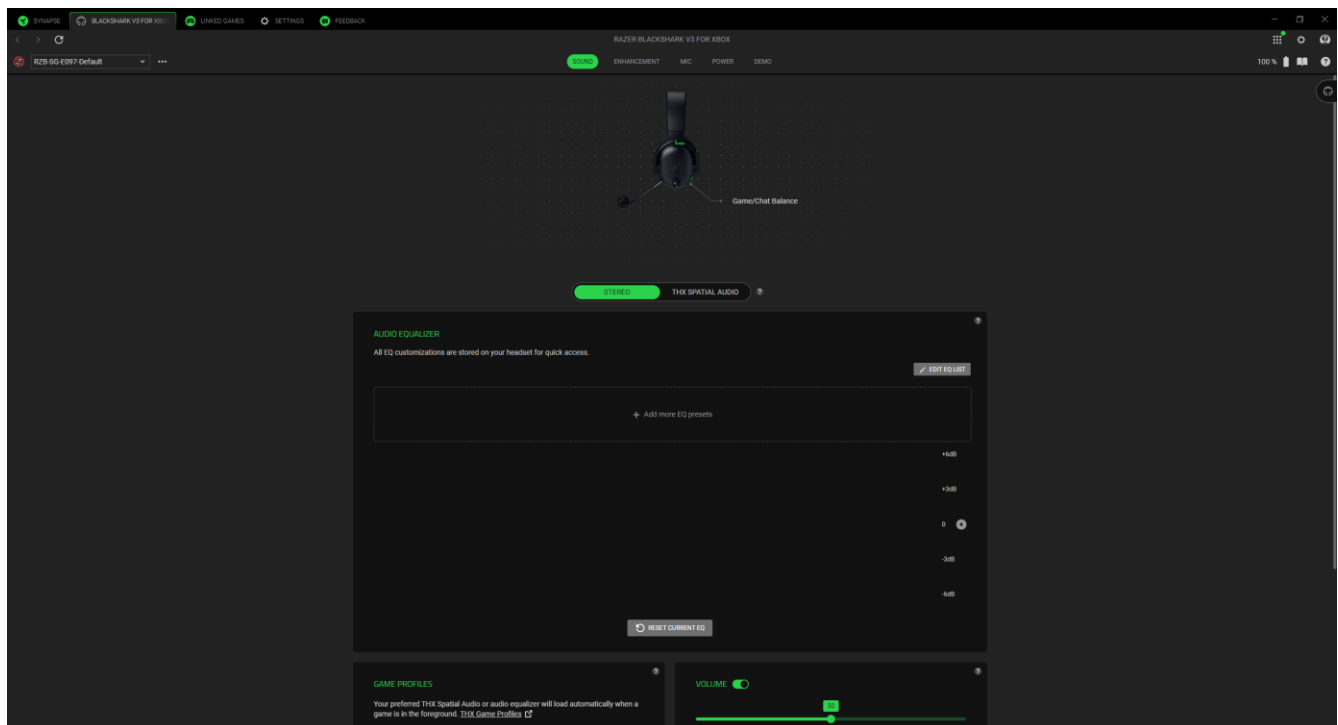

Profile

Profile is a data storage system that keeps all your Razer device settings. By default, the profile name is based on your system's name. Clicking the dropdown bar () will display all profiles for this device

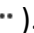
so you can quickly switch between them. To add, import, rename, duplicate, export, or delete a profile, press the profile's corresponding Miscellaneous button ().

Audio equalizer

Select any available equalizer preset created for the best audio experience designed for gaming immersion, movie viewing, or enjoying your favorite music. Manually adjusting any equalizer preset will automatically set it to Custom.

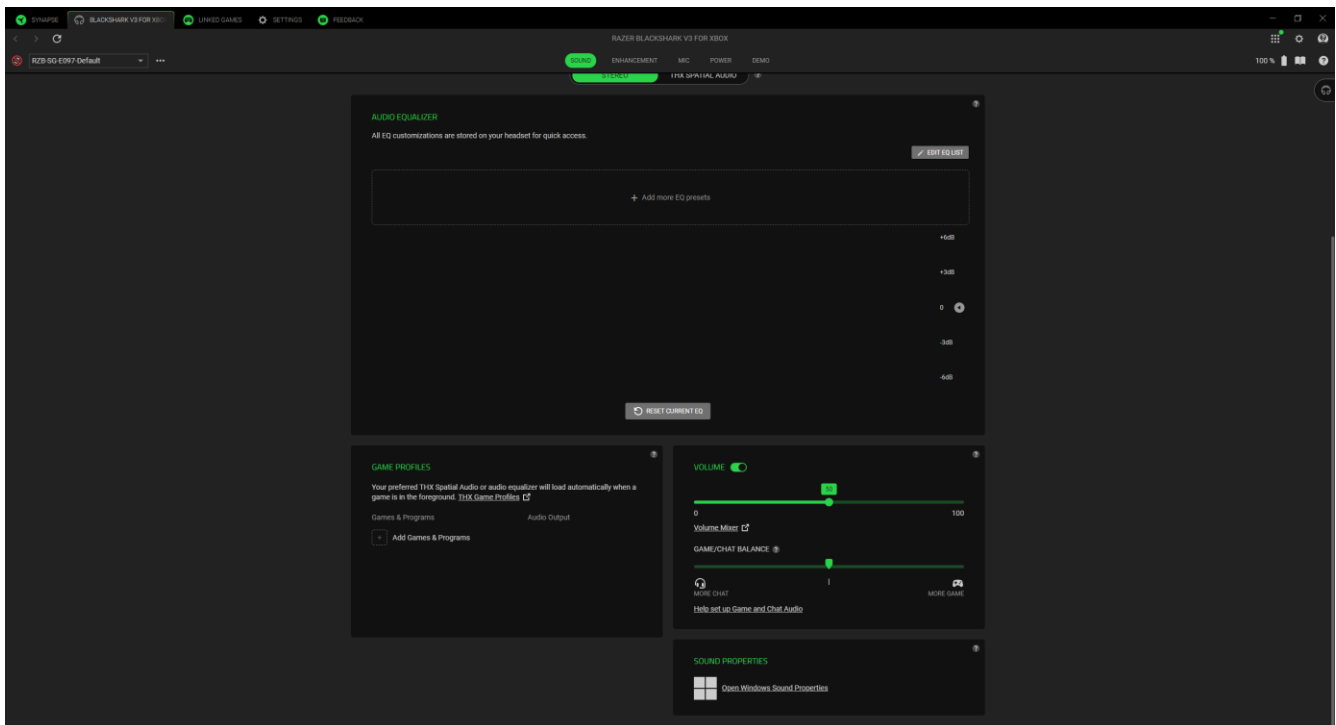

Game Profiles

Set a THX Spatial Audio or EQ preset to load automatically when a game is in the foreground. Click on **Add Games & Programs** to manually add apps and set your preferred audio output for each.

Volume

Adjust the audio volume of the device. You can also adjust the system's overall volume or individual application volumes using the Windows volume mixer.

Game/Chat Balance

Use the slider to change the audio mix of the game and chat channels to make one more audible than the other.

Sound Properties

Launch the Windows Sound Properties window to manage system sound settings, such as playback and recording device configurations, sound schemes, and default communications activity.

Enhancement

The Enhancement subtab is for customizing your audio system's incoming audio settings and frequency response.

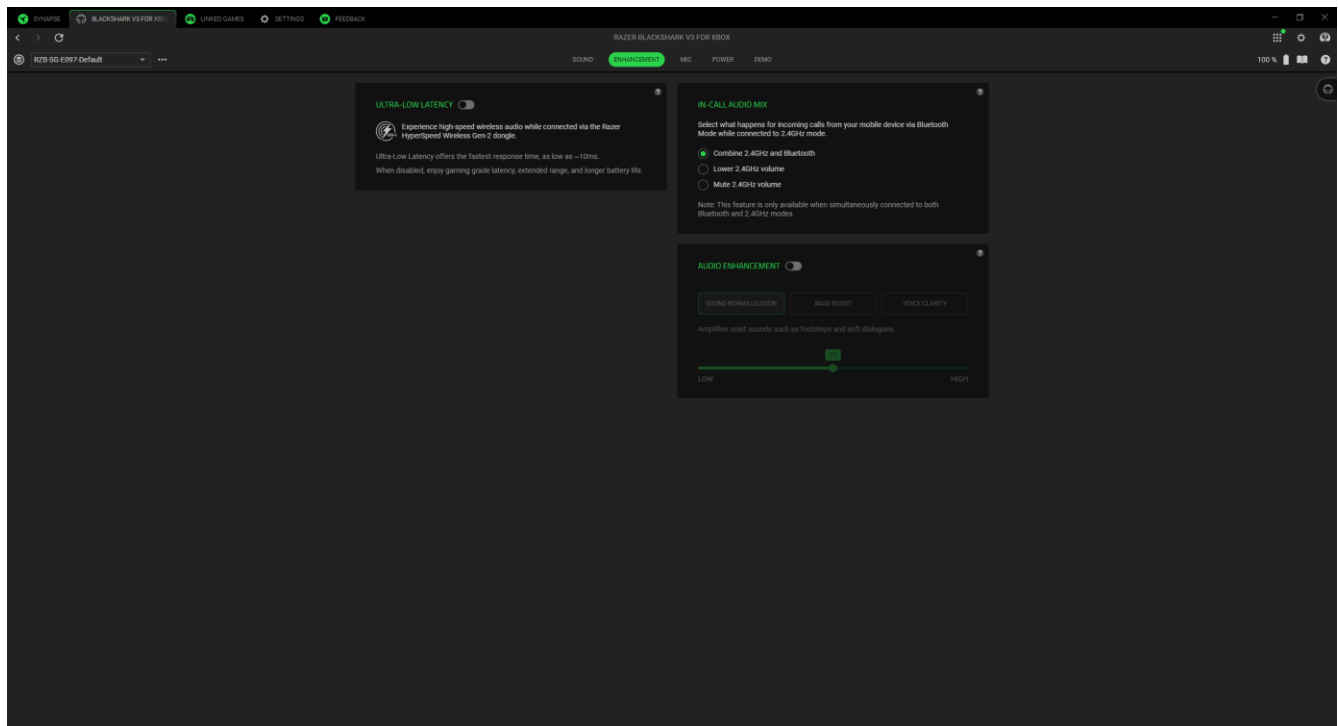

Ultra-Low Latency

Using the Razer Hyperspeed Wireless Gen-2 dongle, you can activate Ultra Low Latency mode, which speeds up communication between your computer and headset but reduces signal range and battery life.

In-Call Audio Mix

This option allows you to set how the audio volume behaves on the dongle when you receive Bluetooth calls while in Simultaneous Audio mode.

Audio Enhancement

Choose one of the options below then use the slider to increase or decrease its effect:

- **Sound Normalization** - Increase the volume of quiet sounds without affecting the louder parts.

- **Bass Boost** - Enhance the low-frequency response to improve the bass output of your headset. When enabled, you can adjust the bass output of the headset by adjusting the bass boost slider.
- **Voice Clarity** - Enhance incoming dialogue from communication applications for clear and easily understandable speech.

Mic

The Mic subtab enables you to change all outgoing mic audio settings.

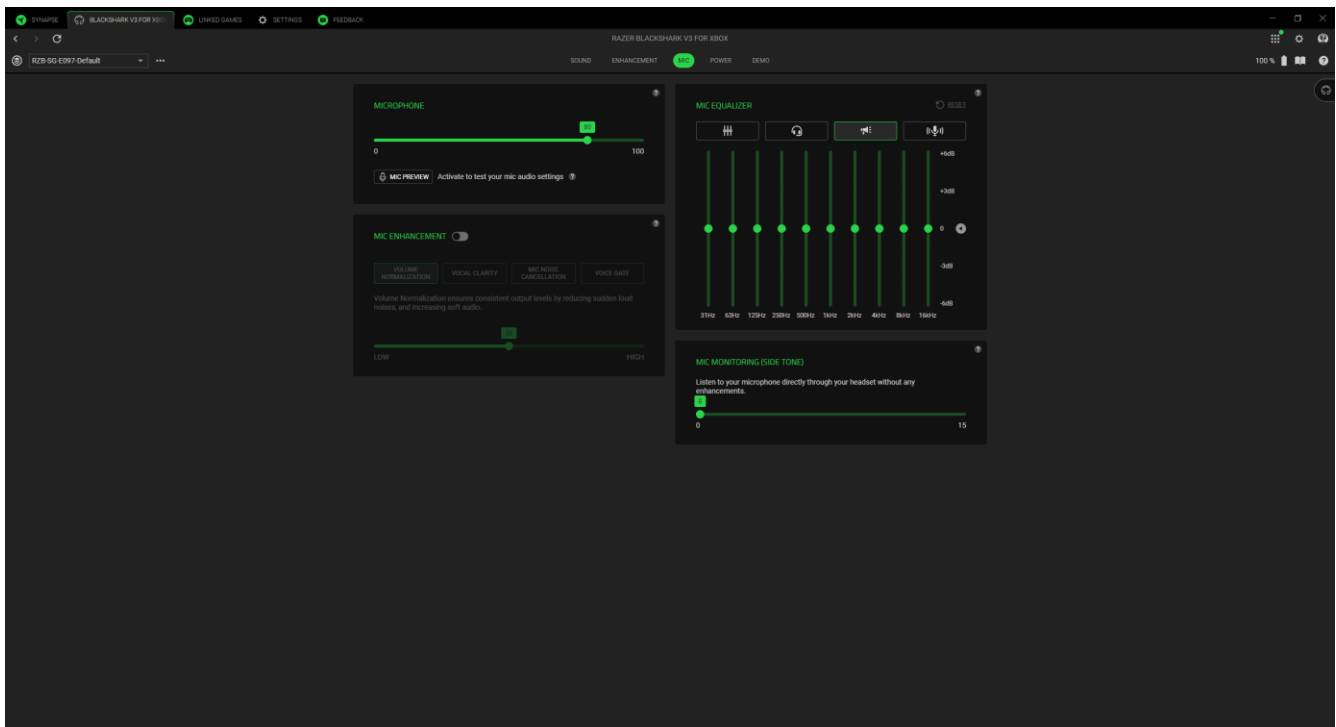

Microphone

Adjust the microphone volume or disable it by using the toggle. You can also activate the Mic Preview to test the microphone's input audio intensity.

Mic Enhancement

Enhance mic input quality by enabling and adjusting the listed features.

- **Volume Normalization.** Reduces the variation of loudness.
- **Vocal Clarity.** Emphasizes the voice frequency.
- **Mic Noise Cancellation.** Suppresses environmental noise.
- **Voice Gate.** Adjust the microphone input sensitivity.

Mic Equalizer

Select the mic equalizer preset that best suits your mic needs. Manually adjusting any equalizer preset will automatically set it as a Custom preset.

Mic Monitoring (Side tone)

Toggle this setting to monitor your microphone's sound directly via the headset, adjusting the monitoring volume as desired.

Power

For wireless devices, the Power subtab allows you to manage your device's energy consumption when running on batteries.

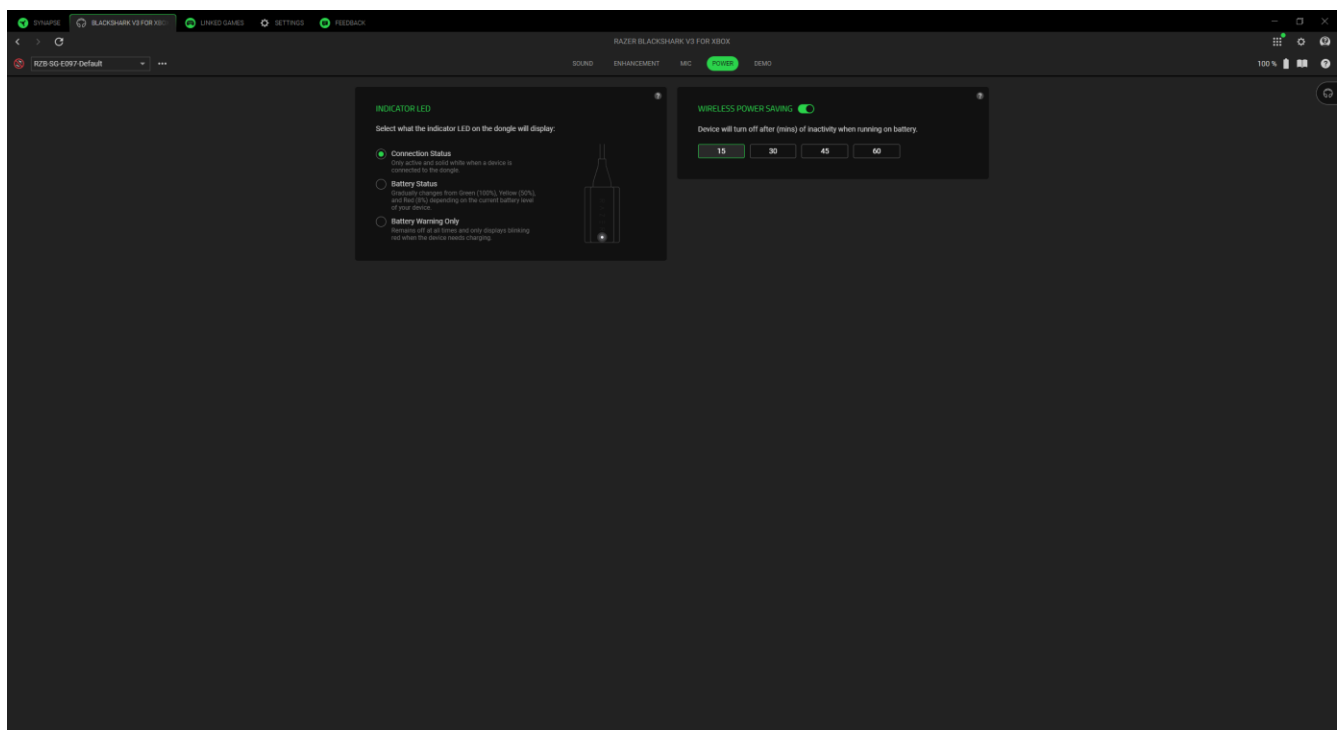

LED Indicator

Choose what the LED indicator will show on the dongle.

Wireless Power Saving

Set the device to power off when it has been idle for a certain amount of time.

Demo

Explore all your customizations and enhancements in the Demo subtab.

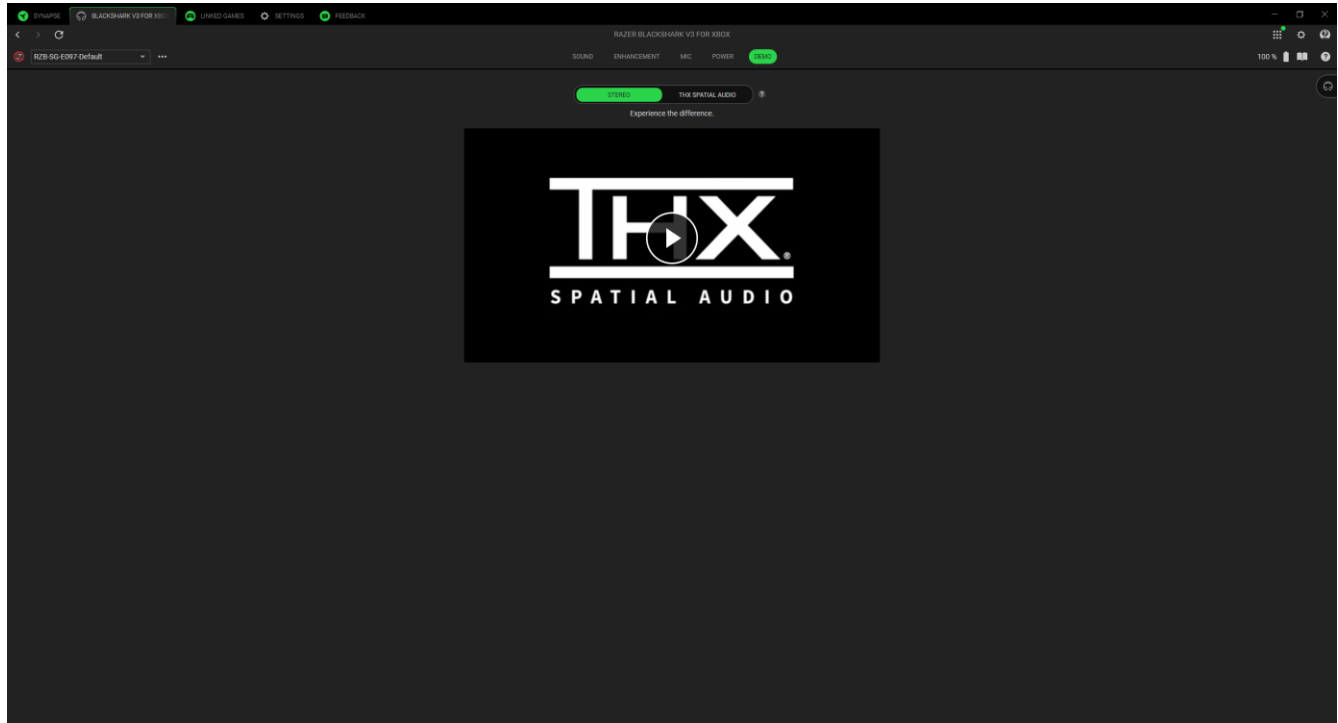

Stereo / THX Spatial Audio

Switch between Stereo audio and THX Spatial Audio modes.

LINKED GAMES

The Linked Games tab allows you to add apps, view peripherals linked to apps, or search for listed apps.

Games

The Games subtab enables you to link apps to your peripherals. You can also sort apps based on alphabetical order, last played, or most played. Apps will still be listed here, even if not linked to a Razer device. To add an app that is not listed on the screen, you can use the Add button (+) to search for it manually or use the Scan button (🔍) to search for it automatically. Click the Search button (🔍) to look for a specific game or program from the list.

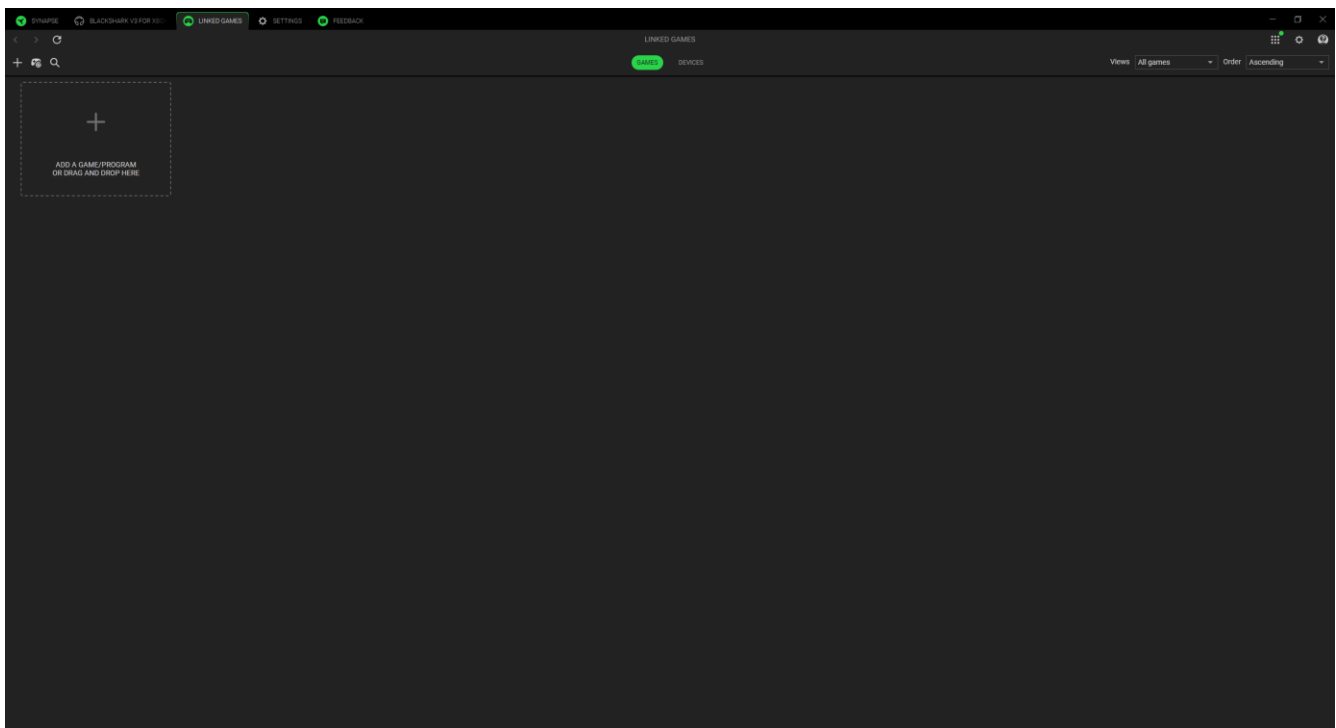

To link an app to your Razer device, click on it from the list and select a device and its profile. This will automatically set your device to the selected profile whenever you launch the app.

Devices

The Devices subtab lets you view your peripherals and determine which apps are linked to them. By selecting a device, you can see a list of linked apps, add new apps, or remove linked apps. You can filter these apps by using the Views and Order dropdown list. To add an app not listed on your peripheral, you can drag and drop the executable file inside the box or use the Add button (+) to open the search window. While inside the search window, you can click the Refresh button (↻) to rescan installed apps, the Search button (🔍) to look for a specific game or program from the list, or the Browse link to search for the app manually.

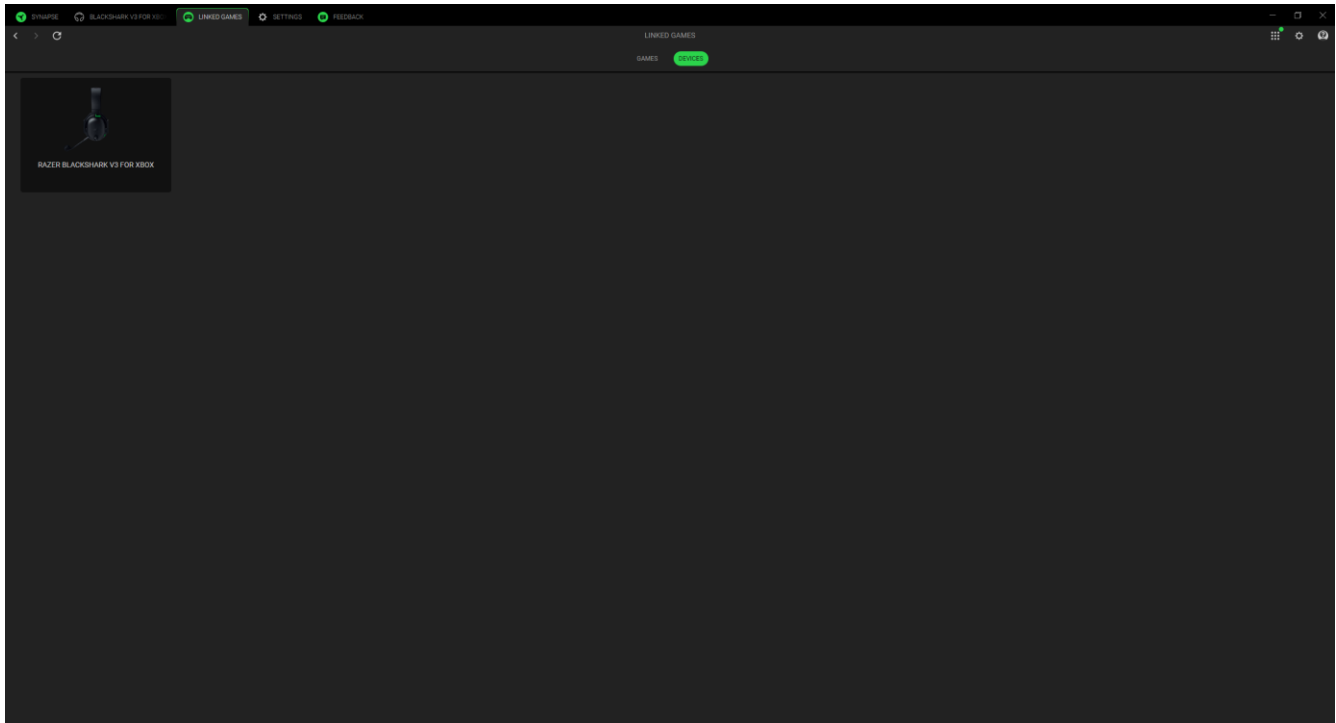

To link an app to your Razer device, click the tick box at the top left corner of the app while inside the search box. This will automatically set your device to the selected profile whenever you launch the app.

SETTINGS

The Settings tab, accessible by clicking the (⚙) button, enables you to configure numerous options as listed below:

Synapse

The Synapse subtab is where you can find options that are specific to the app.

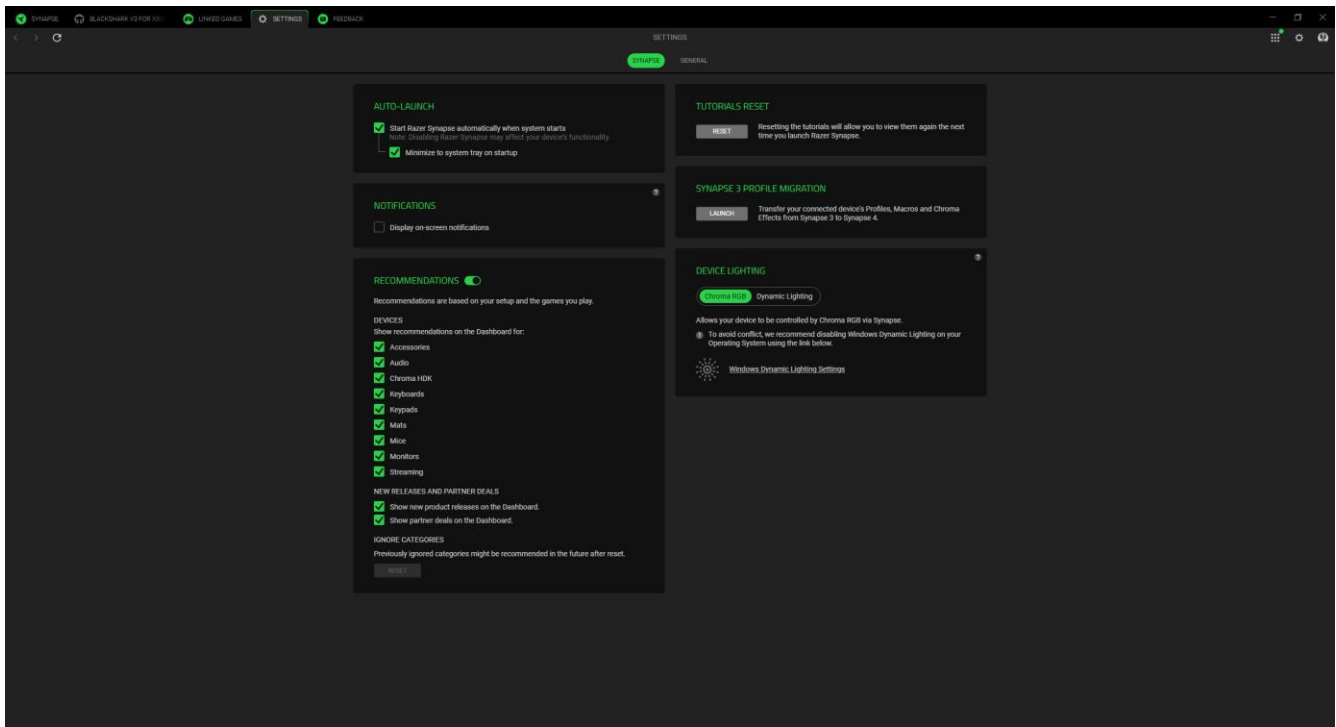

Auto Launch

The Auto Launch option enables you to configure the app's startup behavior.

Notifications

The Notifications option allows the app to display on-screen notifications even if you run full-screen apps.

Recommendations

Recommendations enable us to show the latest products and features on your Dashboard based on your installed devices and linked games.

Tutorials Reset

Selecting the Reset button will reactivate all tutorials that help you acquaint yourself with Razer Synapse's features.

Profile Migration

This function lets you transfer all your device's Profiles, Macros, and Chroma Effects from Synapse 3 to the new Synapse.

Device Lighting

This option lets you choose which app will control the lighting effects on your device.

General

The General subtab is the section where you can access miscellaneous options for your app, as well as find additional information about the software.

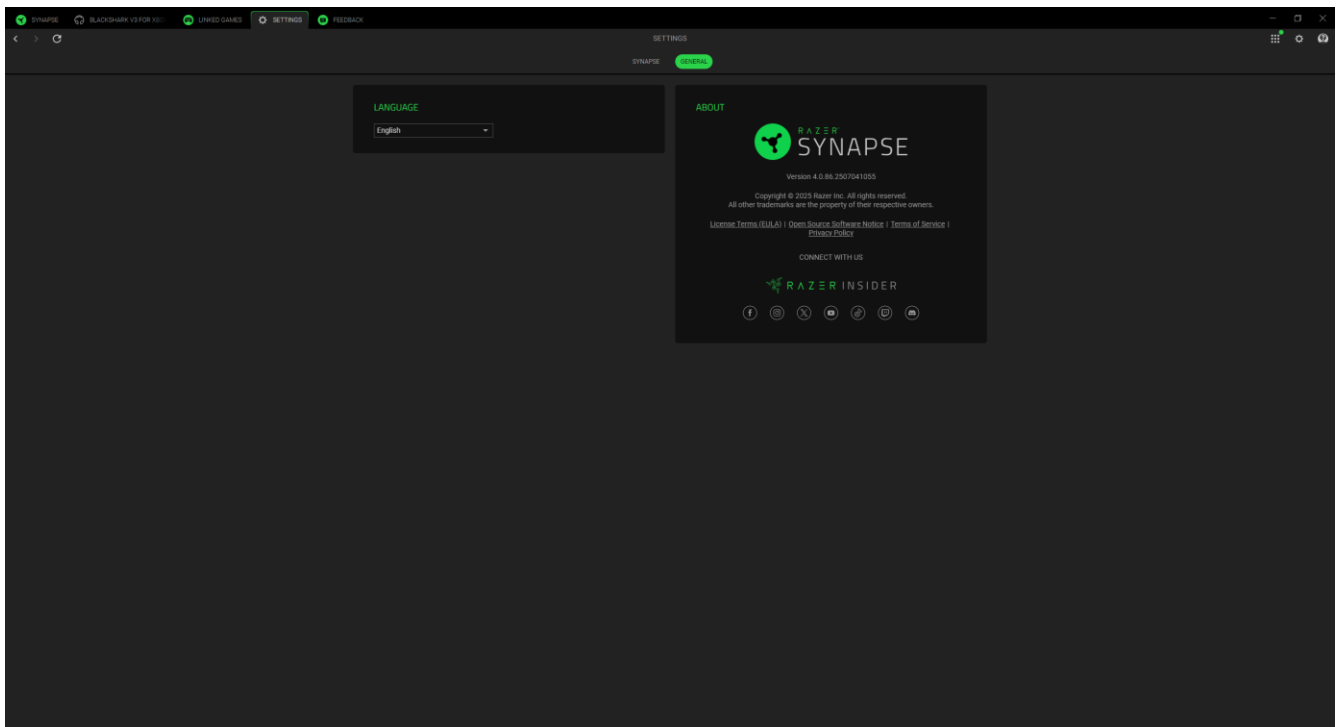

Language

This option lets you change the display language of Razer Synapse.

About

The About section shows the current software version, displays the copyright statement, and provides relevant links for Razer's terms of use. You may also use this option to access Razer's social communities quickly.

FEEDBACK

Help us improve Razer Synapse by giving your comments, suggestions, and problems with the software. You can contact us directly using this tab and even earn rewards for reporting bugs.

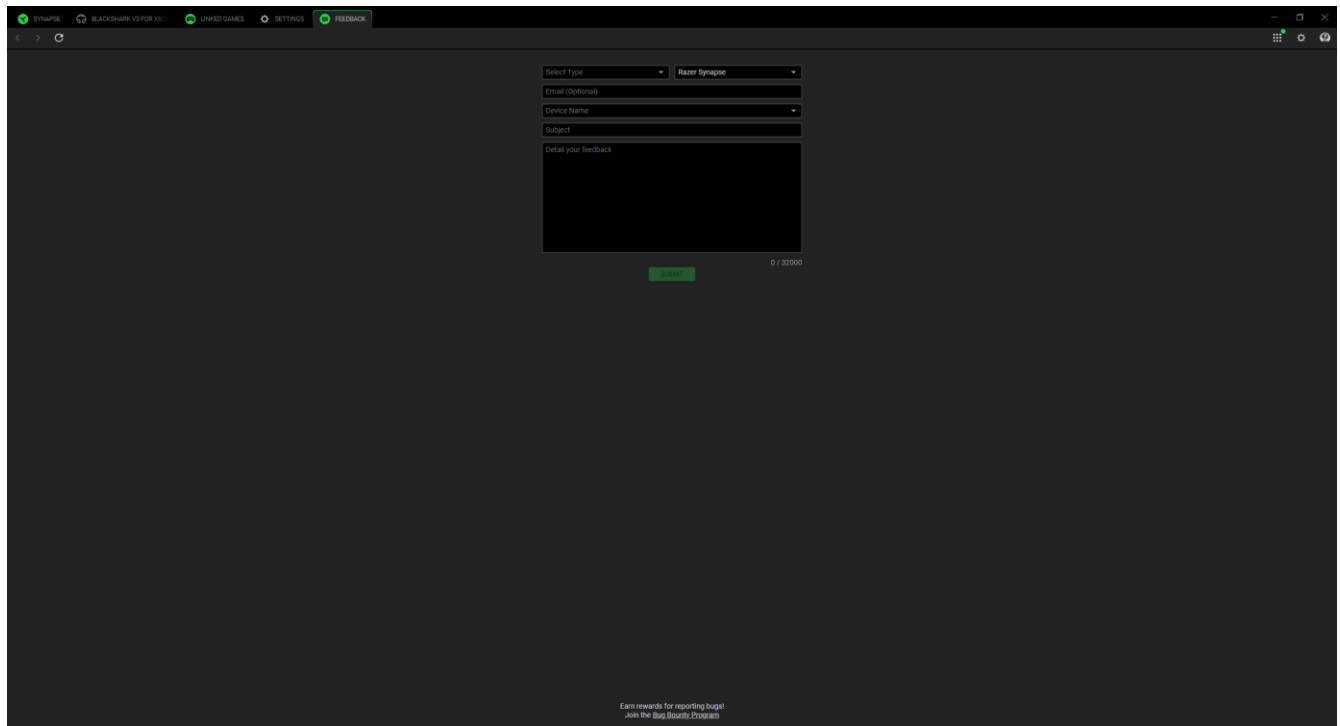

The screenshot shows the Razer Synapse application interface with the 'FEEDBACK' tab selected. The window has a dark theme. At the top, there is a navigation bar with icons for 'SYNAPSE', 'BLACKSHARK VESPA FOR PC', 'LINKED GAMES', 'SETTINGS', and 'FEEDBACK'. The 'FEEDBACK' tab is active. Below the navigation bar, the feedback form is displayed. It includes a 'Select Type' dropdown menu with 'Razer Synapse' selected. Below this are input fields for 'Email (Optional)', 'Device Name', and 'Subject'. A large text area labeled 'Detail your feedback' is provided for the user to enter their comments. A green 'Submit' button is located at the bottom right of the form. A character count '0 / 20000' is visible next to the button. At the bottom of the window, there is a small text prompt: 'Earn rewards for reporting bugs! Join the Razer Rewards Program'.

7. SAFETY AND MAINTENANCE

SAFETY GUIDELINES

In order to achieve maximum safety while using your Razer headset, we suggest that you adopt the following guidelines:

Should you have trouble operating the device properly and troubleshooting does not work, unplug the device and contact the Razer hotline or go to support.razer.com for assistance.

Don't take apart the device, and don't attempt to operate it under abnormal current loads. Doing so will void your warranty.

Keep the device away from liquid, humidity, or moisture. Operate the device only within the specific temperature range of 0°C (32°F) to 40°C (104°F). Should the temperature exceed this range, unplug and/or switch off the device to stabilize the temperature to an optimal level.

We recommend stretching your Razer headset gently apart before placing them over your head to minimize headband stress. However, please avoid overstretching the headset beyond its technical limits.

The device isolates external ambient sounds even at low volumes, resulting in lowered awareness of your external surroundings. Please remove the device when engaging in activities requiring active awareness of your surroundings.

Listening to excessively loud volumes over extended periods can damage your hearing. Furthermore, legislation of certain countries permits a maximum sound level of 86db to affect your hearing for 8 hours a day. We, therefore, recommend that you reduce the volume to a comfortable level when listening for prolonged periods. Please, take good care of your hearing.

MAINTENANCE AND USE

Your Razer headset requires minimum maintenance to keep it in optimum condition. Once a month, we recommend you clean the device using a soft cloth or cotton swab to prevent dirt buildup. Don't use soap or harsh cleaning agents.

8. LEGALESE

COPYRIGHT AND INTELLECTUAL PROPERTY INFORMATION

©2025 Razer Inc. All rights reserved. Razer, the triple-headed snake logo, Razer logo, and “For Gamers. By Gamers.”, are trademarks or registered trademarks of Razer Inc. and/or affiliated companies in the United States or other countries. All other trademarks are the property of their respective owners.

Microsoft, Xbox, Xbox "Sphere" Design, Xbox Series X|S, Xbox One and Windows 11 are trademarks of the Microsoft group of companies. All other trademarks are the property of their respective owners.

Android, Google, Google Logo, Google Play, and the Google Play logo are trademarks of Google LLC.

Apple, the Apple logo, and iPhone are trademarks of Apple Inc., registered in the U.S. and other countries. App Store is a service mark of Apple Inc.

Copyright © 2003-2023 by Bluetooth SIG, Inc. The Bluetooth® word mark and logos are registered trademarks owned by Bluetooth SIG, Inc.

Windows and the Windows logo are trademarks or registered trademarks of the Microsoft group of companies.

Razer Inc. (“Razer”) may have copyright, trademarks, trade secrets, patents, patent applications, or other intellectual property rights (whether registered or unregistered) concerning the product in this guide. Furnishing of this guide does not give you a license to any such copyright, trademark, patent or other intellectual property right. Your Razer BlackShark V3 For Xbox (the “Product”) may differ from pictures whether on packaging or otherwise. Razer assumes no responsibility for such differences or for any errors that may appear. Information contained herein is subject to change without notice.

LIMITED PRODUCT WARRANTY

For the latest and current terms of the Limited Product Warranty, please visit [razer.com/warranty](https://www.razer.com/warranty).

LIMITATION OF LIABILITY

Razer shall in no event be liable for any lost profits, loss of information or data, special, incidental, indirect, punitive or consequential or incidental damages, arising in any way out of distribution of, sale of, resale of, use of, or inability to use the Product. In no event shall Razer’s liability exceed the retail purchase price of the Product.

GENERAL

These terms shall be governed by and construed under the laws of the jurisdiction in which the Product was purchased. If any term herein is held to be invalid or unenforceable, then such term (in so far as it is invalid or unenforceable) shall be given no effect and deemed to be excluded without invalidating any of the remaining terms. Razer reserves the right to amend any term at any time without notice.